

INTERSTATE ROAD CLOSURE USING RAMPS WITH CROSSROAD CLOSURE

Closure for More Than Five Days

DELINEATOR DRUMS
47 EA
FLEXIBLE DELINEATORS
71 EA
OBLITERATION OF PAVEMENT MARKING
75 SF

D-704-54

Use with D-704-53 and D-704-55.

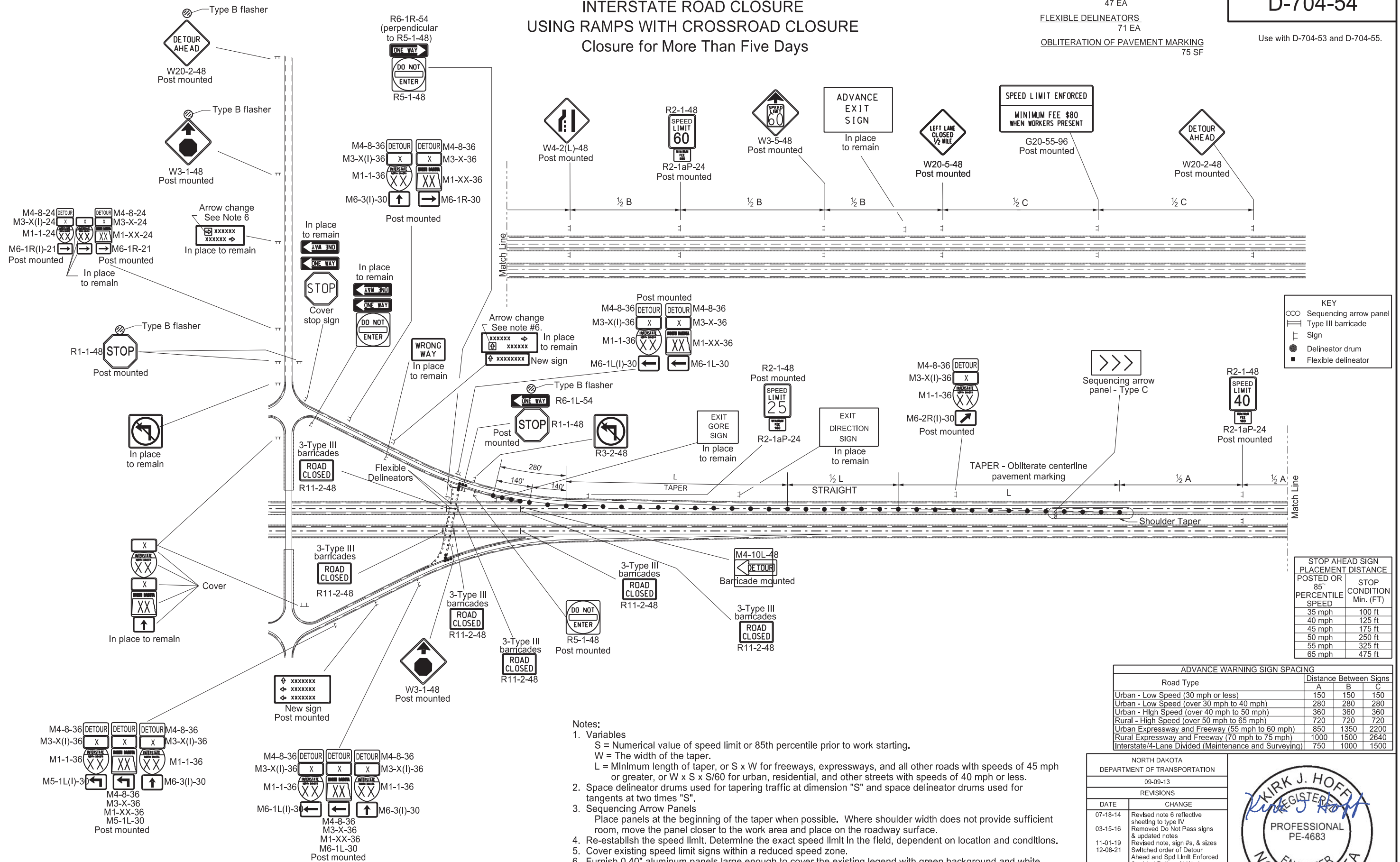

KEY

- Sequencing arrow panel
- ▬ Type III barricade
- ⊥ Sign
- Delineator drum
- ▬ Flexible delineator

STOP AHEAD SIGN PLACEMENT DISTANCE

POSTED OR 85% PERCENTILE SPEED	STOP CONDITION Min. (FT)
35 mph	100 ft
40 mph	125 ft
45 mph	175 ft
50 mph	250 ft
55 mph	325 ft
65 mph	475 ft

ADVANCE WARNING SIGN SPACING

Road Type	Distance Between Signs		
	A	B	C
Urban - Low Speed (30 mph or less)	150	150	150
Urban - Low Speed (over 30 mph to 40 mph)	280	280	280
Urban - High Speed (over 40 mph to 50 mph)	360	360	360
Rural - High Speed (over 50 mph to 65 mph)	720	720	720
Urban Expressway and Freeway (55 mph to 60 mph)	850	1350	2200
Rural Expressway and Freeway (70 mph to 75 mph)	1000	1500	2640
Interstate/4-Lane Divided (Maintenance and Surveying)	750	1000	1500

Notes:

1. Variables
 - S = Numerical value of speed limit or 85th percentile prior to work starting.
 - W = The width of the taper.
 - L = Minimum length of taper, or S x W for freeways, expressways, and all other roads with speeds of 45 mph or greater, or W x S x S/60 for urban, residential, and other streets with speeds of 40 mph or less.
2. Space delineator drums used for tapering traffic at dimension "S" and space delineator drums used for tangents at two times "S".
3. Sequencing Arrow Panels
 - Place panels at the beginning of the taper when possible. Where shoulder width does not provide sufficient room, move the panel closer to the work area and place on the roadway surface.
4. Re-establish the speed limit. Determine the exact speed limit in the field, dependent on location and conditions.
5. Cover existing speed limit signs within a reduced speed zone.
6. Furnish 0.40" aluminum panels large enough to cover the existing legend with green background and white legend Type IV reflective sheeting to change sign messages.
7. Sign G20-55-96 is not required if this layout is part of other traffic control that contains this sign.

NORTH DAKOTA
DEPARTMENT OF TRANSPORTATION

09-09-13

REVISIONS

DATE	CHANGE
07-18-14	Revised note 6 reflective sheeting to type IV
03-15-16	Removed Do Not Pass signs & updated notes
11-01-19	Revised note, sign #s, & sizes
12-08-21	Switched order of Detour Ahead and Spd Limit Enforced & added Dollars At Work
11-29-22	Removed Dollars At Work



11/29/22