

PLEASANT LAKE  
SEC'S. 4 & 5, T. 156 N., R. 71 W.

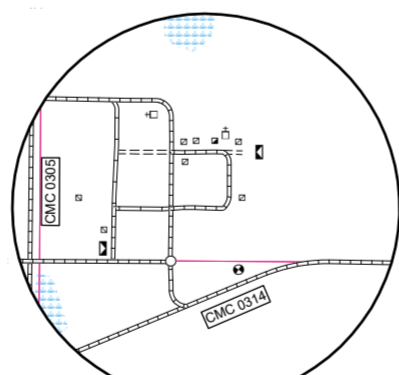

FILLMORE  
SEC'S. 4, 5, 8, & 9, T. 154 N., R. 71 W.

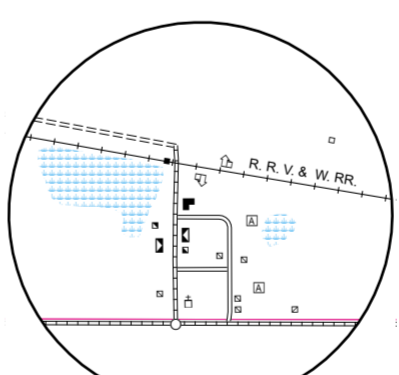

FLORA  
SEC'S. 30 & 31, T. 152 N., R. 68 W.



STATE OF NORTH DAKOTA  
DIAGRAM OF COUNTIES

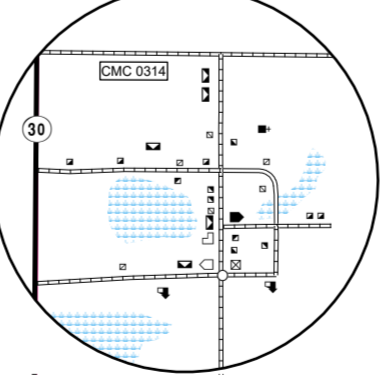

HARLOW  
SEC'S. 10, 15, & 16, T. 154 N., R. 69 W.

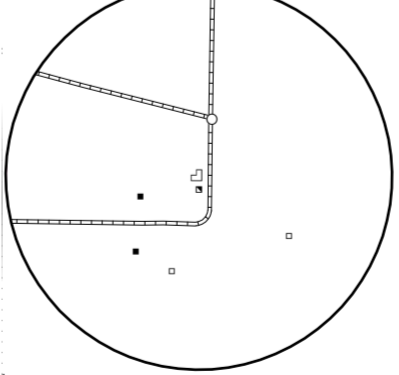

BAKER  
SEC. 15, T. 154 N., R. 70 W.

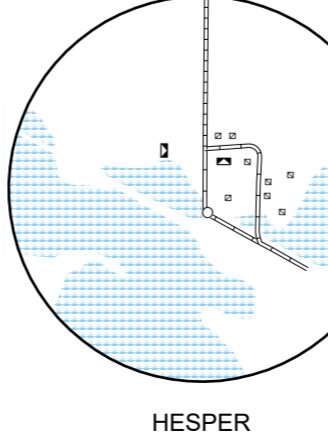

HESPER  
SEC. 16, T. 152 N., R. 70 W.

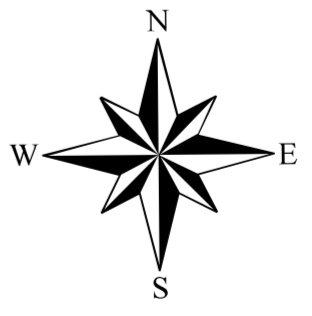

# GENERAL HIGHWAY MAP BENSON COUNTY NORTH DAKOTA

PREPARED BY THE  
NORTH DAKOTA DEPARTMENT OF TRANSPORTATION  
PLANNING AND ASSET MANAGEMENT DIVISION

IN COOPERATION WITH THE  
U.S. DEPARTMENT OF TRANSPORTATION  
FEDERAL HIGHWAY ADMINISTRATION

SCALE  
1 0.5 0 1 2 3 4 Miles

SCALE FOR ENLARGEMENTS  
0 0.25 0.5 Miles

1 0.5 0 1 2 3 4 Kilometers

2022

BASED ON AERIAL PHOTOGRAPHY OF 1957  
AERIAL INVENTORY OF 2022  
UNIVERSAL TRANSVERSE MERCATOR ZONE 14  
NORTH AMERICAN DATUM 83

NAME AND LOCATION OF ORGANIZED CIVIL TOWNSHIPS  
THOSE UNORGANIZED ARE SO NOTED

T. 156 N. - R. 71 W. PLEASANT LAKE	T. 153 N. - R. 71 W. ESMOND	T. 151 N. - R. 67 W. OBERON
T. 156 N. - R. 70 W. KNOX	T. 153 N. - R. 70 W. ISABEL	T. 152 N. - R. 67 W. LALLIE
T. 156 N. - R. 69 W. YORK	T. 153 N. - R. 69 W. ALBERT	T. 153 N. - R. 66 W. LALLIE
T. 156 N. - R. 68 W. LEEDS	T. 153 N. - R. 68 W. ELDON	T. 152 N. - R. 66 W. LALLIE
T. 156 N. - R. 67 W. IRVINE	T. 153 N. - R. 67 W. WEST BAY	T. 151 N. - R. 65 W. UNORGANIZED
T. 155 N. - R. 71 W. IOWA	T. 153 N. - R. 66 W. UNORGANIZED	T. 152 N. - R. 65 W. GRAND HARBOR
T. 155 N. - R. 70 W. TWIN LAKE	T. 153 N. - R. 64 W. MISSION	T. 151 N. - R. 71 W. EAST FORK
T. 155 N. - R. 69 W. BEAVER	T. 153 N. - R. 63 W. MISSION	T. 151 N. - R. 70 W. ARNE
T. 155 N. - R. 68 W. LAKE IBSEN	T. 152 N. - R. 65 W. CREEK	T. 151 N. - R. 69 W. SOUTH VIKING
T. 155 N. - R. 67 W. NORMANIA	T. 152 N. - R. 64 W. MISSION	T. 151 N. - R. 68 W. WEST ANTELOPE
T. 154 N. - R. 71 W. IMPARK	T. 152 N. - R. 63 W. MISSION	T. 151 N. - R. 66 W. ROCK
T. 154 N. - R. 70 W. BROE	T. 152 N. - R. 63 W. LOHNES	T. 151 N. - R. 65 W. TWIN TREE
T. 154 N. - R. 69 W. BUTTE VALLEY	T. 152 N. - R. 71 W. RICH VALLEY	T. 151 N. - R. 71 W. RICH VALLEY
T. 154 N. - R. 68 W. MC CLELLAN	T. 152 N. - R. 70 W. HESPER	T. 151 N. - R. 64 W. WOOD LAKE
T. 154 N. - R. 67 W. RIGGIN	T. 152 N. - R. 69 W. NORTH VIKING	T. 151 N. - R. 62 W. WARWICK
T. 154 N. - R. 66 W. RIGGIN	T. 152 N. - R. 68 W. AURORA	T. 151 N. - R. 63 W. WARWICK
T. 153 N. - R. 66 W. RIGGIN	T. 152 N. - R. 67 W. OBERON	T. 151 N. - R. 62 W. MINCO

Notice of Disclaimer  
The North Dakota Department of Transportation (NDOT) makes this map available on an "as is" basis as a public service. Under no circumstances does NDOT warrant or certify the information to be free of errors or deficiencies of any kind. NDOT specifically disclaims all warranties, express or implied, including but not limited to the warranties of merchantability and fitness for a particular purpose.