

INSET NO. 1
SECS 4, 5, 8, & 9, T. 162 N., R. 70 W.

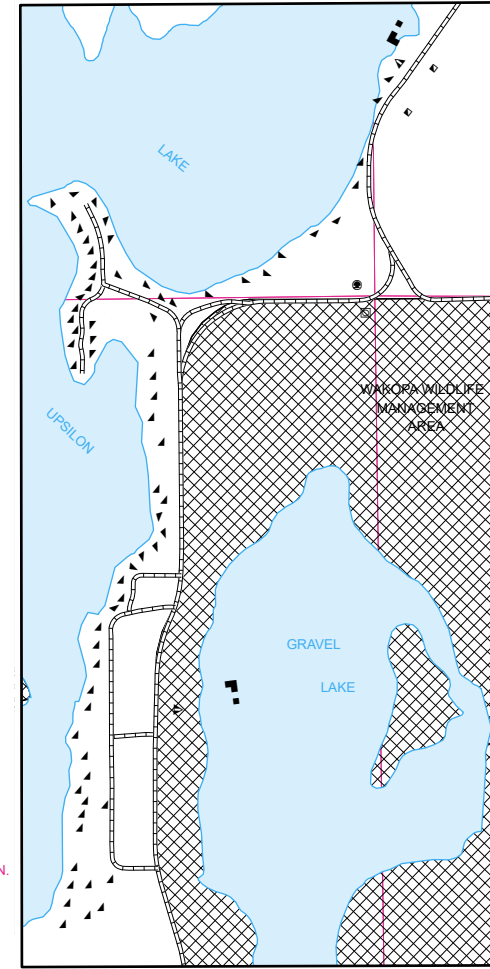

INSET NO. 2
SECS 2, 3, 10, & 11, T. 163 N., R. 71 W.

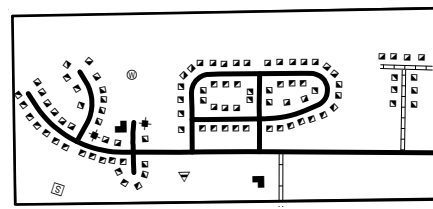

INSET NO. 7
SEC. 4, T. 161 N., R. 71 W.

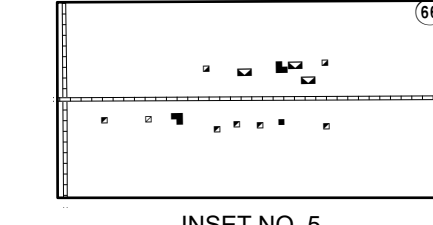

INSET NO. 5
SECS. 20, & 29, T. 160 N., R. 71 W.

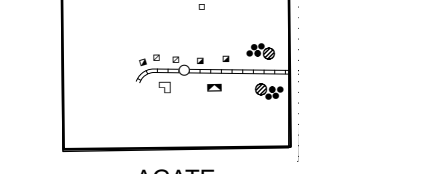

AGATE
SEC. 1, T. 159 N., R. 69 W.

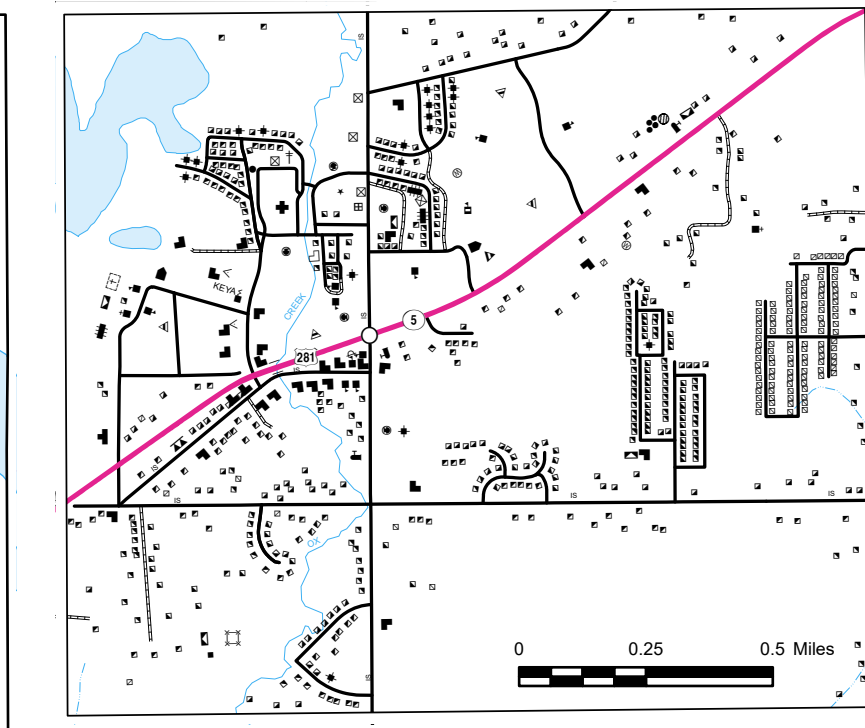

BELCOURT
SECS. 20, 21, 28, & 29, T. 162 N., R. 70 W.

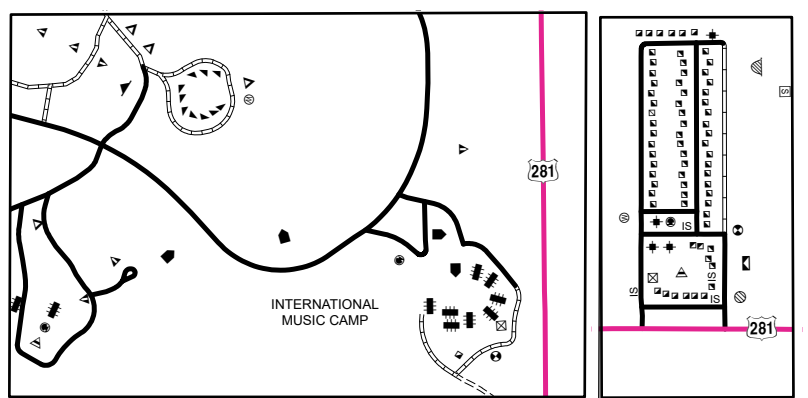

INTERNATIONAL PEACE GARDEN
SEC. 31, T. 164 N., R. 72 W.
SEC. 36, T. 164 N., R. 73 W.

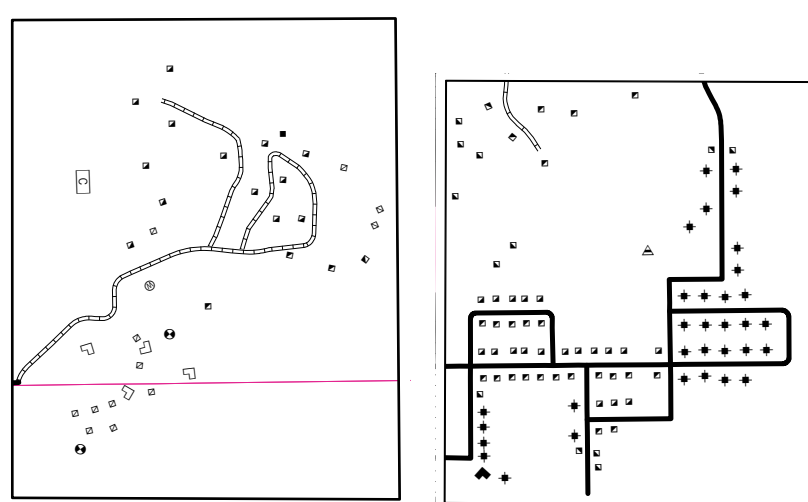

SAN HAVEN
SECS. 19, & 30, T. 162 N., R. 72 W.

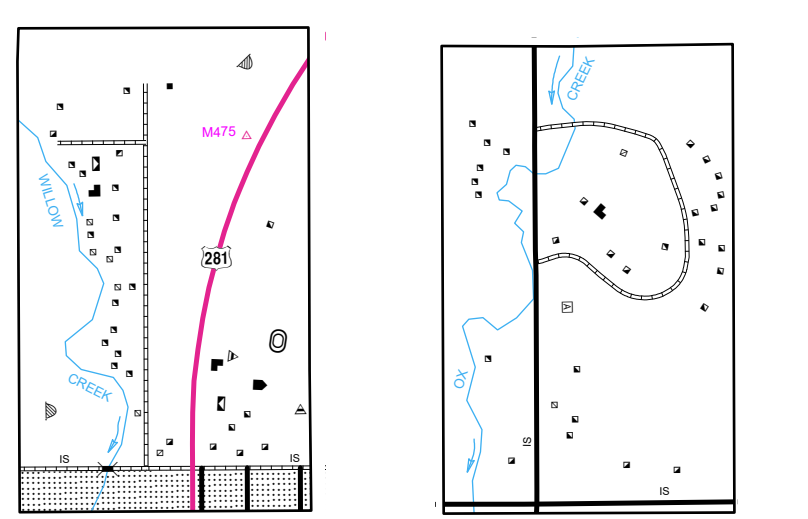

DUNSEITH NO. 1
SECS. 25 & 36, T. 162 N., R. 73 W.

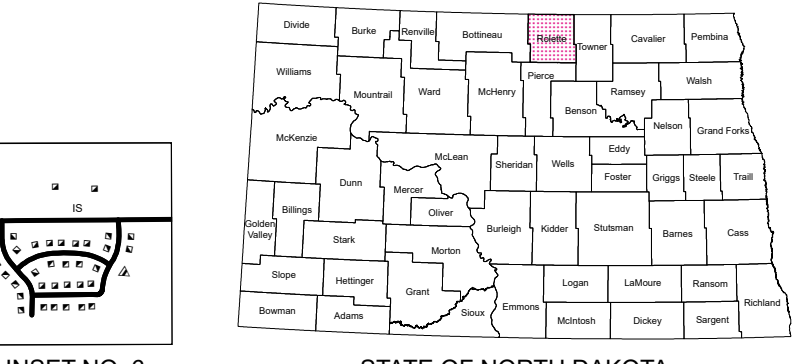

INSET NO. 3
SECS. 16, & 17, T. 162 N., R. 70 W.

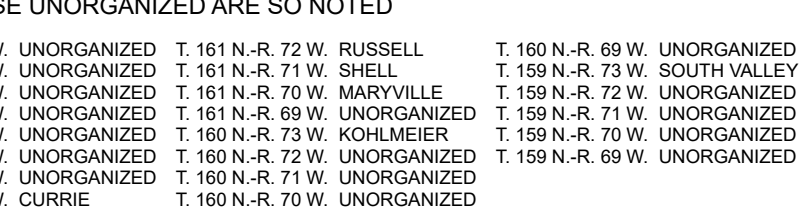

INSET NO. 6
SECS. 23 & 26, T. 162 N., R. 70 W.

GENERAL LEGEND

ROADS AND ROADWAY FEATURES

- PRIMITIVE ROAD
- UNIMPROVED ROAD
- GRAVEL GRADED AND DRAINED ROAD
- PAVED ROAD
- STREETS IN UNINCORPORATED AREAS
- INDIAN SERVICE ROAD
- COUNTY MAJOR COLLECTOR
- ROUTE NUMBER
- POINTS BETWEEN WHICH DISTANCES ARE MEASURED
- U.S. NUMBERED HIGHWAY
- STATE HIGHWAY SYSTEM

BOUNDARIES

- MONUMENTED BOUNDARY MARKER
- NATIONAL BOUNDARY LINE
- STATE OR PROVINCE LINE
- COUNTY LINE
- TOWNSHIP LINE
- CORPORATE LINE
- SECTION LINE
- BOUNDARY TO MARK ENLARGEMENT INSET
- NATIONAL REFUGES
- MONUMENT - SMALL HISTORIC SITE
- WILDLIFE MANAGEMENT AREA
- WATERFOWL PRODUCTION AREA
- STATE SCHOOL LAND
- NATIONAL PARKS AND OTHER RESERVATIONS
- STATE FOREST

DRAINAGE

- INTERMITTENT STREAM (NARROW)
- NARROW STREAM
- WIDE STREAM
- WIDE STREAM WITH DAM
- LAKE, RESERVOIR, OR POND WITH DAM
- LAKE, RESERVOIR, OR POND
- MARSH OR SWAMP LAND

STRUCTURES

- HIGHWAY BRIDGE, GENERAL
- HIGHWAY GRADE SEPARATION
- DAM WITH ROAD
- MINOR DRAINAGE STRUCTURE
- CONCRETE FORD OR DIP

RAILROADS

- RAILROAD (ANY NUMBER OF TRACKS USED BY A SINGLE OPERATING CO.)
- RAILROAD STATION

CITY AND VILLAGE CENTERS

- COUNTY SEAT
- OTHER CITIES AND VILLAGES (GENERALIZED)
- INCORPORATED CITY OR VILLAGE (GENERALIZED)

EDUCATIONAL AND CORRECTIONAL INSTITUTIONS

- SCHOOLHOUSE
- OTHER EDUCATIONAL INSTITUTIONS
- TOWNHALL, GRANGE, OR COMMUNITY HALL
- MUSEUM - GENERAL

AIRPORTS

- AIRFIELD, LIMITED FACILITIES
- LANDING AREA OR STRIP

NAVIGATION

- DOCK, PIER, OR LANDING

NATURAL FEATURES

- PROMINENT ELEVATION - WITH NAME

FARM UNITS, DWELLINGS, ETC.

- FARM UNIT (FARM UNITS SHOWN IN MUNICIPAL LIMITS INDICATE FARM BUILDINGS FOR FARM USE)
- DWELLING OTHER THAN FARM
- ROWS OR GROUPS OF DWELLINGS
- CLOSELY SPACED FIGURE DENOTES NUMBER OF DWELLINGS
- BARRACKS, OR DORMATORIES FOR STUDENTS, WORKERS, MIGRANTS, ETC.
- SEASONAL OR SUMMER COLONY DWELLING
- SEASONAL DWELLINGS CLOSELY SPACED
- HOTEL OR INN
- CHURCH
- CEMETERY
- CHURCH WITH CEMETERY ADJACENT
- HOSPITAL
- WELL
- TENANT HOUSE, MULTIPLE HOUSING, DUPLEX, ETC.
- FIRST AID STATION OR HEALTH CENTER

INDUSTRIAL

- STORE OR SMALL BUSINESS ESTABLISHMENT
- FACTORY OR INDUSTRIAL PLANT
- OIL TANK
- GAS TANK
- GROUP OF STORAGE TANKS (OIL OR GAS)
- FILLING STATION
- GAUGING OR PUMPING STATION
- WAREHOUSE - GENERAL
- GRAIN ELEVATOR
- STOCK YARD - LOADING PEN OR CORRAL
- GRAVEL PIT
- CRUSHING PLANT
- WIND TURBINE

PUBLIC SERVICE FACILITIES

- HIGHWAY GARAGE
- FIRE ENGINE HOUSE
- GARBAGE OR RUBBISH DUMP
- SEWAGE DISPOSAL PLANT
- AUTOMOBILE GRAVEYARD
- WATER SUPPLY STAND PIPE OR TANK
- POWER SUBSTATION
- BROADCASTING STATION (RADIO OR TV)
- COMMUNICATION TOWER
- POLICE STATION
- MUNICIPAL BUILDING
- CANADIAN BORDER CUSTOMS STATION
- U.S. BORDER CUSTOMS STATION

CONSERVATION AND RECREATION

- PICNIC GROUND
- PLAYGROUND, BALL FIELD, ETC.
- BATHING BEACH OR SWIMMING POOL
- CAMP SITE, NO PERMANENCE (TENTS OR TRAILER PARKING)
- TOURIST COURT, OR MOTEL
- CAMP OR LODGE (PERMANENT SITE WITH BUILDINGS)
- GOLF GROUND OR COUNTRY CLUB
- FAIR GROUND, RACE COURSE, SPEEDWAY
- GUIDE HOUSE OR GATE HOUSE
- RIFLE CLUB
- ROADSIDE SPRING
- RIDING ACADEMY

MISCELLANEOUS

- TRIANGULATION STATION
- DOT TO INDICATE LOCATION OF ANY CULTURAL FEATURE
- SHOWN OUT OF POSITION
- ALL VACANT CULTURE INDICATED BY OPEN SYMBOL
- LATITUDE AND LONGITUDE

GENERAL HIGHWAY MAP

ROLETTE COUNTY

NORTH DAKOTA

PREPARED BY THE
NORTH DAKOTA DEPARTMENT OF TRANSPORTATION
PLANNING AND ASSET MANAGEMENT DIVISION

IN COOPERATION WITH THE
U.S. DEPARTMENT OF TRANSPORTATION
FEDERAL HIGHWAY ADMINISTRATION

SCALE
1 0.5 0 1 2 3 4 Miles
SCALE FOR ENLARGEMENTS UNLESS OTHERWISE NOTED
0 0.25 0.5 Miles
1 0.5 0 1 2 3 4 Kilometers

2021

BASED ON AERIAL PHOTOGRAPHY OF 1953
AERIAL INVENTORY OF 2021

UNIVERSAL TRANSVERSE MERCATOR ZONE 14
NORTH AMERICAN DATUM 83

SHEET 1 OF 1

Notice of Disclaimer
The North Dakota Department of Transportation (NDOT) makes this map available on an "as is" basis as a public service. Under no circumstances does NDOT warrant or certify the information to be free of errors or deficiencies of any kind. NDOT specifically disclaims all warranties, express or implied, including but not limited to the warranties of merchantability and fitness for a particular purpose.