

2007 FUNCTIONAL CLASSIFICATION

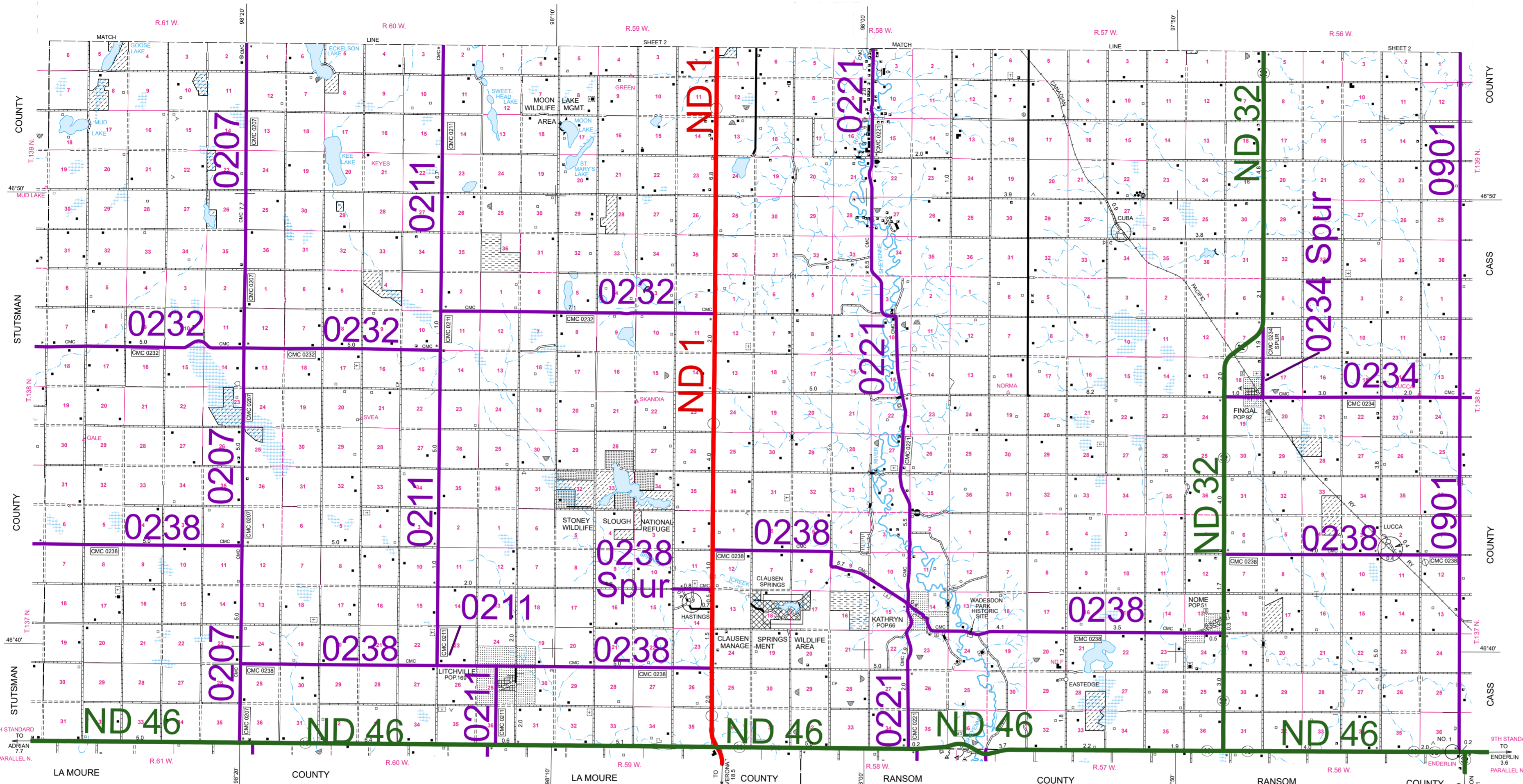

GENERAL LEGEND	
ROADS AND ROADWAY FEATURES	BOUNDARIES
PRIMITIVE ROAD	COUNTY LINE
UNIMPROVED ROAD	TOWNSHIP LINE
GRADED AND DRAINED ROAD	CORPORATE LINE
GRAVEL GRADED AND DRAINED ROAD	SECTION LINE
PAVED ROAD	MATCH LINE BETWEEN ADJOINING SHEETS OF SAME COUNTY
STREETS IN UNINCORPORATED AREAS	BOUNDARY TO MARK ENLARGEMENT INSET
INTERCHANGE	NATIONAL REFUGES
COUNTY MAJOR COLLECTOR	MONUMENT - SMALL HISTORIC SITE
ROUTE NUMBER	WILDLIFE MANAGEMENT AREA
DISTANCES ARE MEASURED	WATERFOWL PRODUCTION AREA
INTERSTATE NUMBERED HIGHWAY	STATE PARKS
U.S. NUMBERED HIGHWAY	STATE SCHOOL LAND
STATE HIGHWAY SYSTEM	
	AIRPORTS
	AIRFIELD, LIMITED FACILITIES
	LANDING AREA OR STRIP
	AIRWAY LIGHT BEACON, GENERAL
	AIRPORT, GENERAL
	RAILROADS
	RAILROAD (ANY NUMBER OF TRACKS USED BY A SINGLE OPERATING CO.)
	RAILROAD STATION
	RAILROAD GRADE CROSSING
	RAILROAD ABOVE
	RAILROAD BELOW
	DRAINAGE
	INTERMITTENT STREAM (NARROW)
	NARROW STREAM
	WIDE STREAM
	WIDE STREAM WITH DAM
	LAKE, RESERVOIR, OR POND
	WITH DAM
	MARSH OR SWAMP LAND
	DRAINAGE DITCH
	NAVIGATION
	DOCK, PIER, OR LANDING
	STRUCTURES
	HIGHWAY BRIDGE, GENERAL
	HIGHWAY GRADE SEPARATION
	DAM WITH ROAD
	MINOR DRAINAGE STRUCTURE
	CONCRETE FORD OR DIP
	FORD - ROAD ESTABLISHED
	FARM UNITS, DWELLINGS, ETC.
	FARM UNIT (FARM UNITS SHOWN IN MUNICIPAL LIMITS INDICATE FARM BUILDINGS FOR FARM USE)
	DWELLING OTHER THAN FARM
	ROWS OR GROUPS OF DWELLINGS
	CLOSELY SPACED (FIGURE DENOTES NUMBER OF DWELLINGS)
	BARRACKS, OR DORMATORIES FOR STUDENTS, WORKERS, MIGRANTS, ETC.
	SEASONAL OR SUMMER COLONY
	DWELLING
	SEASONAL DWELLINGS CLOSELY SPACED
	CHURCH
	CEMETERY
	CHURCH WITH CEMETERY ADJACENT
	WELL
	TENANT HOUSE
	EDUCATIONAL AND CORRECTIONAL INSTITUTIONS
	SCHOOLHOUSE
	TOWNHALL, GRANGE, OR COMMUNITY HALL
	STATE PRISON FARM
	PUBLIC SERVICE FACILITIES
	POST OFFICE
	HIGHWAY GARAGE
	FIRE ENGINE HOUSE
	GARBAGE OR RUBBISH DUMP
	SEWAGE DISPOSAL PLANT
	AUTOMOBILE GRAVEYARD
	SCRAP METAL
	WATER SUPPLY STAND PIPE OR TANK
	POWER SUBSTATION
	BOOSTER STATION
	COMMUNICATION TOWER
	MUNICIPAL BUILDING
	COURTHOUSE
	CONSERVATION AND RECREATION
	PICNIC GROUND
	PLAYGROUND, BALL FIELD, ETC.
	BATHING BEACH OR SWIMMING POOL
	SCenic SITE
	CAMP SITE, NO PERMANENCE (TENTS OR TRAILER PARKING)
	TOURIST COURT, OR MOTEL
	CAMP OR LODGE
	(PERMANENT SITE WITH BUILDINGS)
	REST AREA
	GOLF GROUND OR COUNTRY CLUB
	AMUSEMENT PARK OR HALL
	FAIR GROUND, RACE COURSE, SPEEDWAY
	FISH HATCHERY
	BIRD SANCTUARY
	RIFLE CLUB
	RIDING ACADEMY
	MISCELLANEOUS
	TRIANGULATION STATION
	FORT, ARMY CAMP, BARRACKS, OR OTHER MILITARY POST
	DOT TO INDICATE LOCATION OF ANY CULTURAL FEATURE SHOWN OUT OF POSITION
	ALL VACANT CULTURE INDICATED BY OPEN SYMBOL
	LATITUDE AND LONGITUDE

LEGEND

- INTERSTATE
- PRINCIPAL ARTERIAL
- MINOR ARTERIAL
- MAJOR COLLECTOR

REVISION DATE AND CHANGE
03-10-2011 Removed 8.5 miles of CMC4730

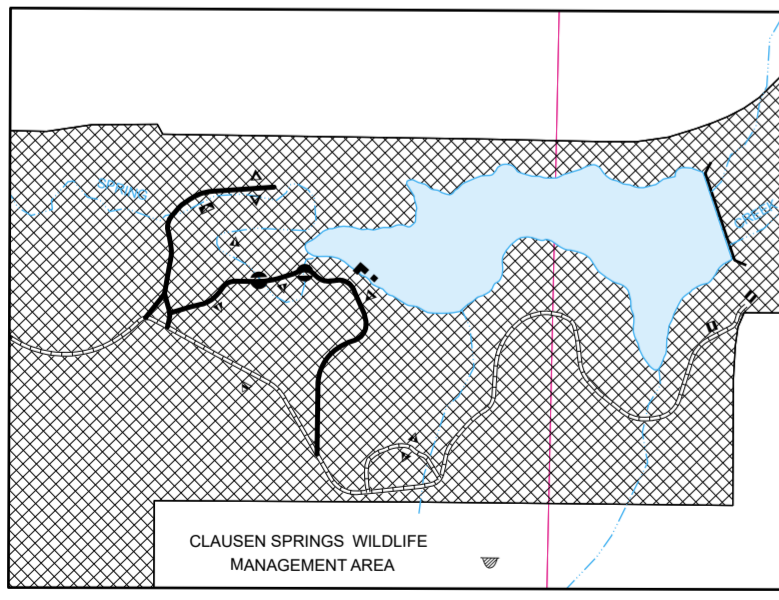
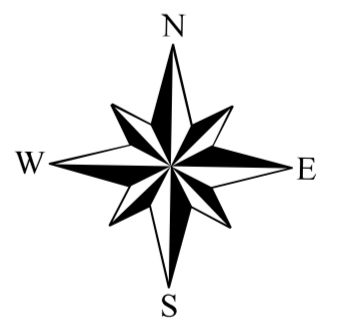

CLAUSEN SPRINGS
SEC'S. 17, & 18, T. 137 N., R. 58 W.

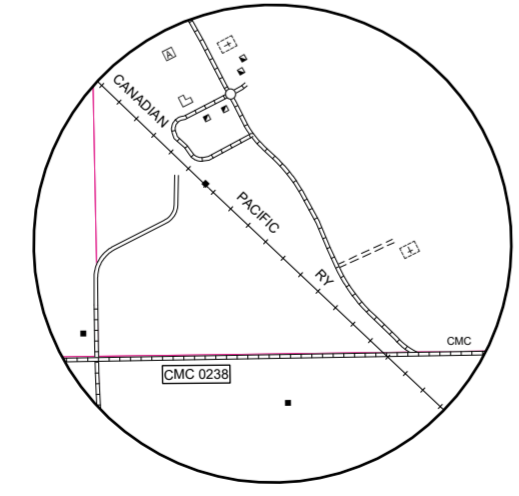

LUCCA
SEC'S. 2, 3, 10, & 11, T. 137 N., R. 56 W.

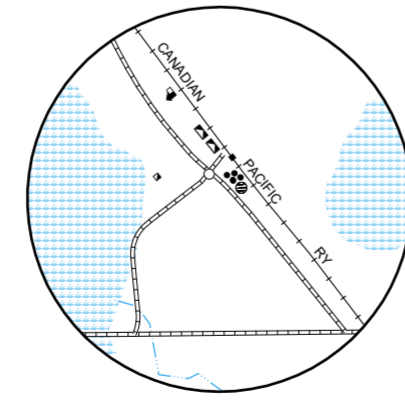

CUBA
SEC'S. 27, & 34, T. 139 N., R. 57 W.

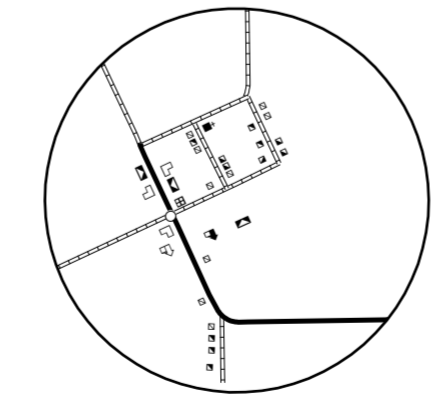

HASTINGS
SEC. 14, T. 137 N., R. 59 W.

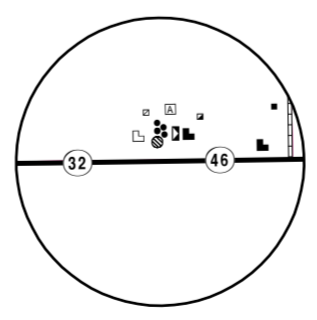

INSET NO. 1
SEC. 2, T. 136 N., R. 56 W.
SEC. 36, T. 137 N., R. 56 W.

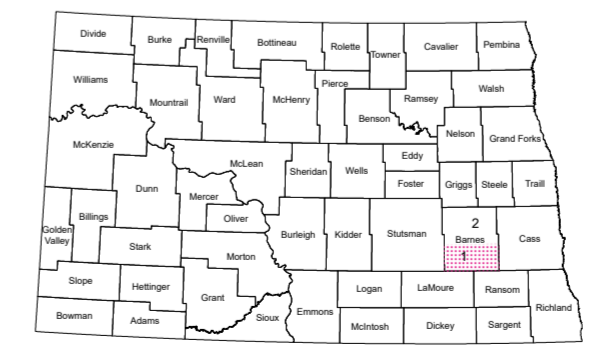

STATE OF NORTH DAKOTA
DIAGRAM OF COUNTIES

GENERAL HIGHWAY MAP BARNES COUNTY NORTH DAKOTA

PREPARED BY THE
NORTH DAKOTA DEPARTMENT OF TRANSPORTATION
PLANNING / ASSET MANAGEMENT DIVISION
IN COOPERATION WITH THE
U.S. DEPARTMENT OF TRANSPORTATION
FEDERAL HIGHWAY ADMINISTRATION

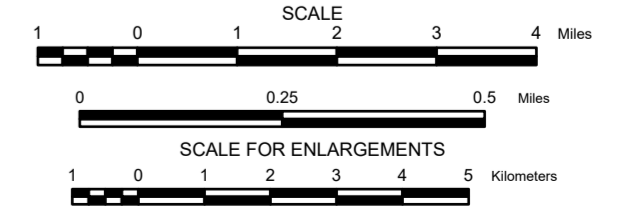

BASED ON AERIAL PHOTOGRAPHY OF 1954
AERIAL INVENTORY OF 2016
2021
UNIVERSAL TRANSVERSE MERCATOR ZONE 14
NORTH AMERICAN DATUM 83

Notice of Disclaimer
The North Dakota Department of Transportation (NDDOT) makes this map available on an "as is" basis as a public service. Under no circumstances does NDDOT warrant or certify the information to be free of errors or deficiencies of any kind. NDDOT specifically disclaims all warranties, express or implied, including but not limited to the warranties of merchantability and fitness for a particular purpose.

COPIES OF THIS MAP ARE AVAILABLE FOR PUBLIC USE AT A NOMINAL COST FROM:
MAP SALES, N.D. DEPT. OF TRANSPORTATION, 608 E. BLVD. AVE., BISMARCK, N.D. 58505-0700