

STATE OF NORTH DAKOTA
DIAGRAM OF COUNTIES

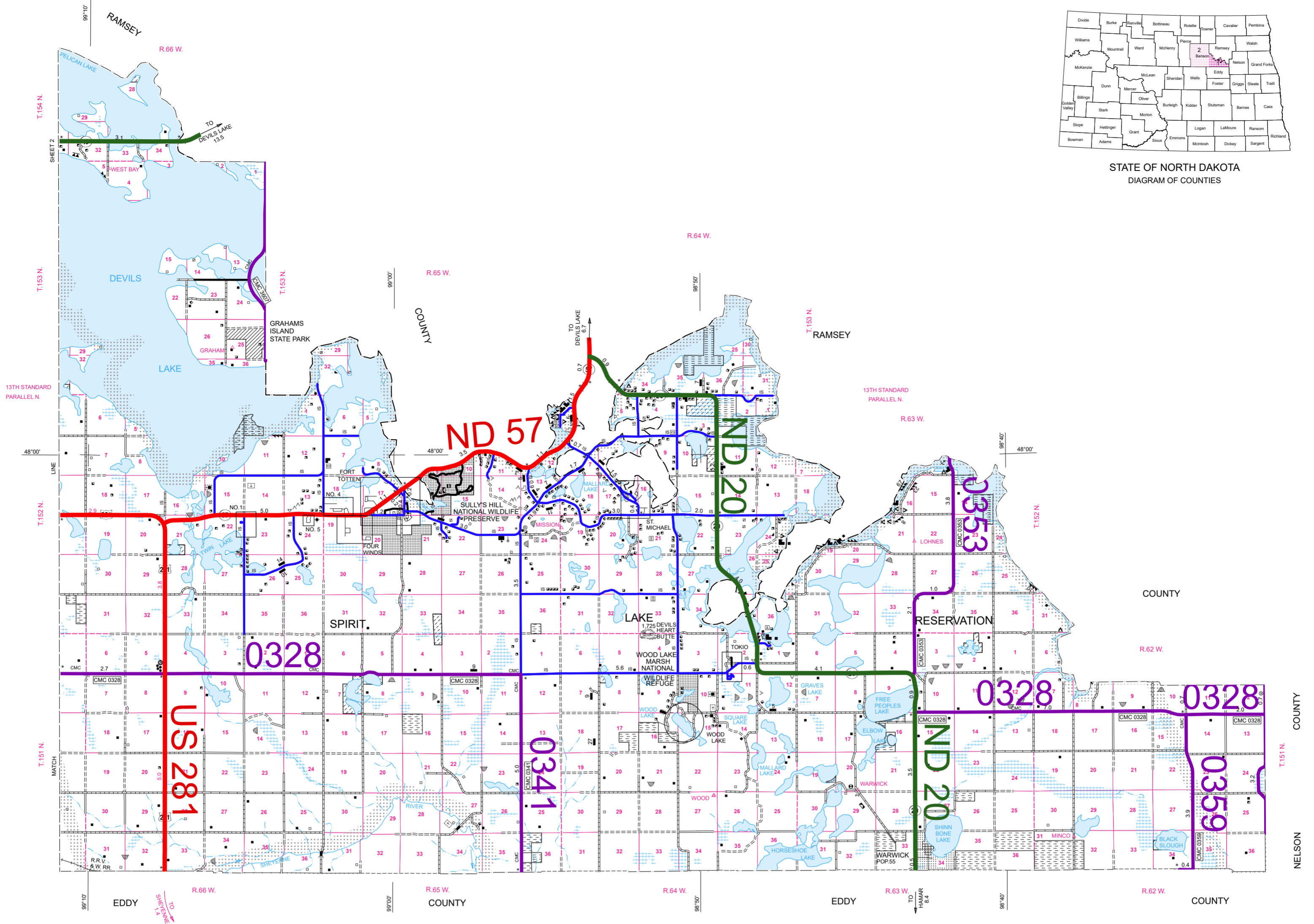

2007 FUNCTIONAL CLASSIFICATION

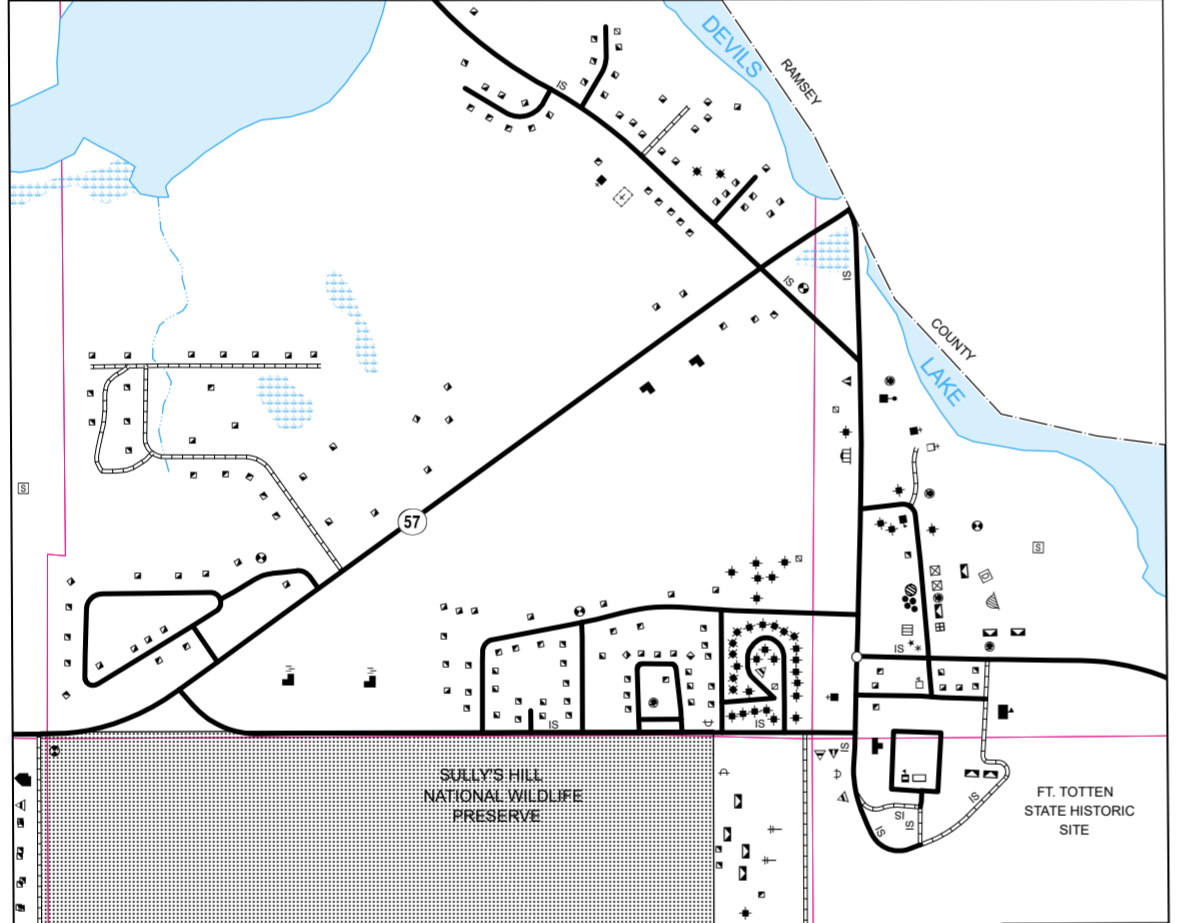

FORT TOTTEN
SECS. 16, 17, 18, 19, 20, 21, T. 152 N., R. 65 W.

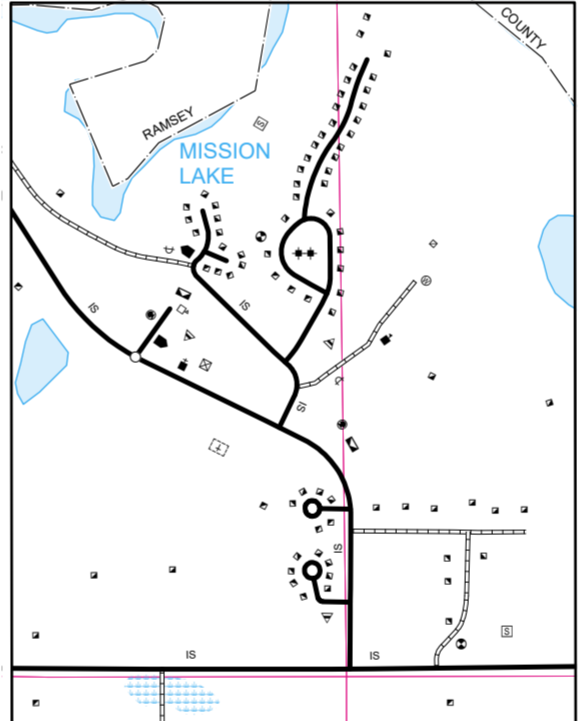

ST MICHAEL
SECS. 16 & 17, T. 152 N., R. 64 W.

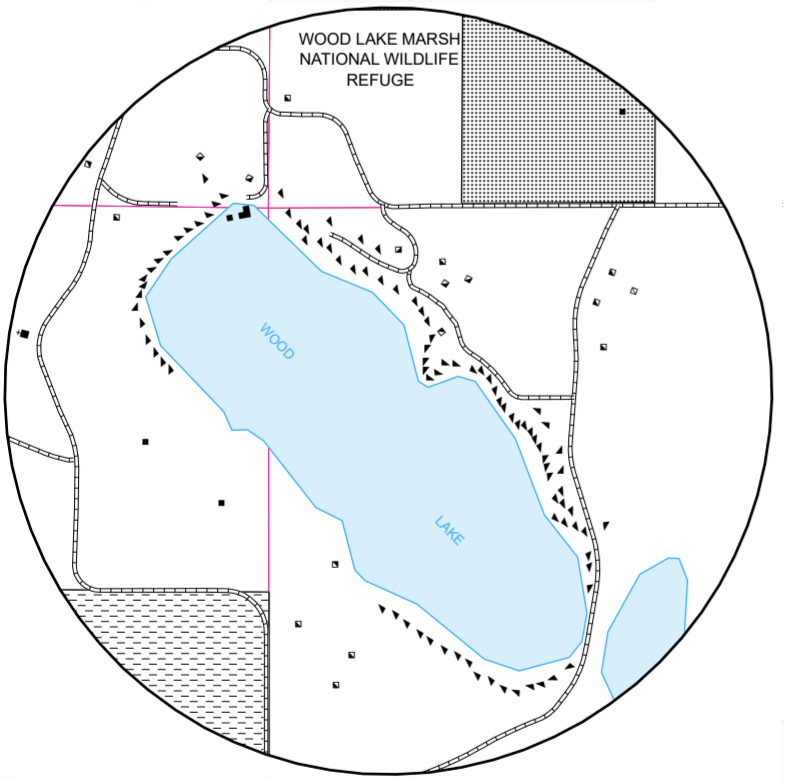

WOOD LAKE
SECS. 9, 10, 15, & 16, T. 151 N., R. 64 W.

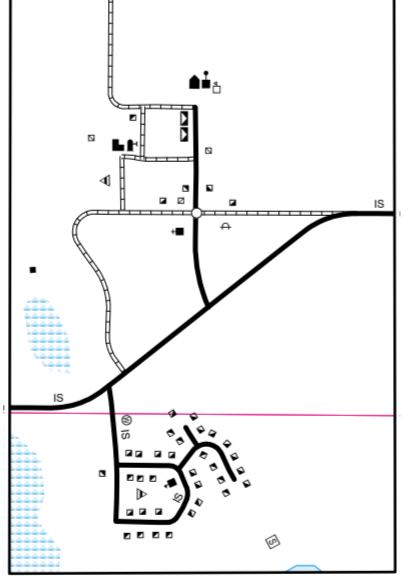

TOKIO
SECS. 2 & 11, T. 151 N., R. 64 W.

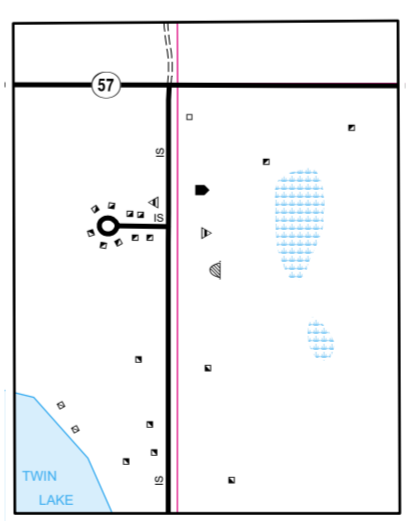

INSET NO. 1
SECS. 14, 15, 22, & 23, T. 152 N., R. 66 W.

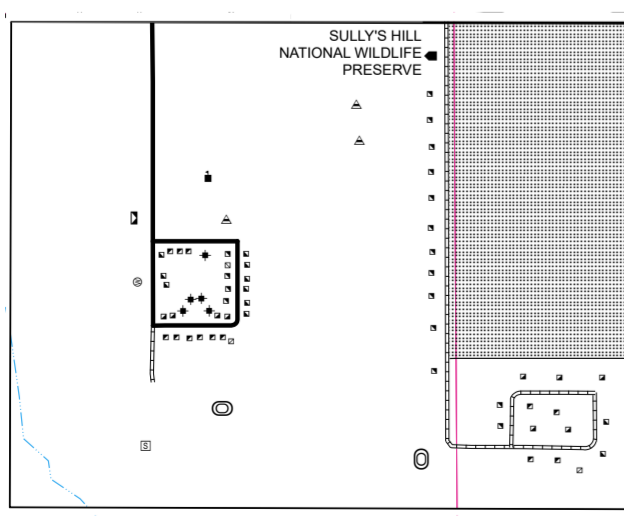

FOUR WINDS
SECS. 17, 18, 19, & 20, T. 152 N., R. 65 W.

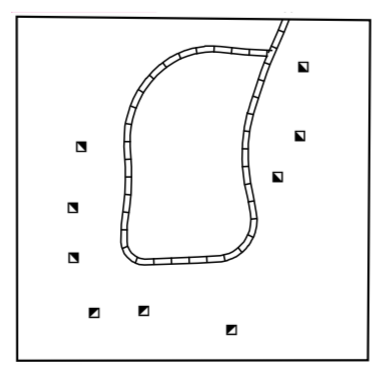

INSET NO. 5
SEC. 24, T. 152 N., R. 66 W.

GENERAL LEGEND	
ROADS AND ROADWAY FEATURES	FARM UNITS, DWELLINGS, ETC.
PRIMITIVE ROAD	FARM UNIT (FARM UNITS SHOWN IN MUNICIPAL LIMITS INDICATE FARM BUILDINGS FOR FARM USE)
UNIMPROVED ROAD	DWELLING OTHER THAN FARM
GRAVEL GRADED AND DRAINED ROAD	ROWS OR GROUPS OF DWELLINGS
GRAVEL GRADED AND DRAINED ROAD	CLOSELY SPACED (FIGURE DENOTES NUMBER OF DWELLINGS)
PAVED ROAD	BARRACKS, OR DORMATORIES FOR STUDENTS, WORKERS, MIGRANTS, ETC.
STREETS IN UNINCORPORATED AREAS	SEASONAL OR SUMMER COLONY
INTERCHANGE	SEASONAL DWELLINGS CLOSELY SPACED
INDIAN SERVICE ROAD	HOTEL OR INN
COUNTY MAJOR COLLECTOR	CHURCH
ROUTE NUMBER	CEMETERY
POINTS BETWEEN WHICH DISTANCES ARE MEASURED	CHURCH WITH CEMETERY ADJACENT
INTERSTATE NUMBERED HIGHWAY	TENANT HOUSE
U.S. NUMBERED HIGHWAY	FIRST AID STATION OR HEALTH CENTER
STATE HIGHWAY SYSTEM	INDUSTRIAL
BOUNDARIES	STORE OR SMALL BUSINESS ESTABLISHMENT
COUNTY LINE	FACTORY OR INDUSTRIAL PLANT
TOWNSHIP LINE	GROUP OF STORAGE TANKS (OIL OR GAS)
CORPORATE LINE	DWELLING
SECTION LINE	GAUGING OR PUMPING STATION
MATCH LINE BETWEEN ADJOINING SHEETS OF SAME COUNTY	WAREHOUSE - GENERAL
BOUNDARY TO MARK ENLARGEMENT INSET	GRAIN ELEVATOR
NATIONAL REFUGES	STOCK YARD - LOADING PEN OR CORRAL
MONUMENT - SMALL, HISTORIC SITE	GRAVEL PIT
WILDLIFE MANAGEMENT AREA	PUBLIC SERVICE FACILITIES
WATERFOWL PRODUCTION AREA	POST OFFICE
STATE PARKS	HIGHWAY GARAGE
STATE SCHOOL LAND	FIRE ENGINE HOUSE
NATIONAL PARKS AND OTHER RESERVATIONS	GARBAGE OR RUBBISH DUMP
DRAINAGE	SEWAGE DISPOSAL PLANT
INTERMITTENT STREAM (NARROW)	AUTOMOBILE GRAVEYARD
NARROW STREAM	WATER SUPPLY STAND PIPE OR TANK
WIDE STREAM	POWER SUBSTATION
WIDE STREAM WITH DAM	COMMUNICATION TOWER
LAKE, RESERVOIR, OR POND	POLICE STATION
WITH DAM	MUNICIPAL BUILDING
MARSH OR SWAMP LAND	COURTHOUSE
DRAINAGE DITCH	CONSERVATION AND RECREATION
CANAL	PICNIC GROUND
RAILROADS	PLAYGROUND, BALL FIELD, ETC.
RAILROAD (ANY NUMBER OF TRACKS USED BY A SINGLE OPERATING CO.)	SCENIC SITE
RAILROAD STATION	CAMP SITE - NO PERMANENCE (TENTS OR TRAILER PARKING)
RAILROAD GRADE CROSSING	TOURIST COURT, OR MOTEL
RAILROAD BELOW	GOLF GROUND OR COUNTRY CLUB
STRUCTURES	FAIR GROUND, RACE COURSE, SPEEDWAY
HIGHWAY BRIDGE, GENERAL	MARINA
HIGHWAY GRADE SEPARATION	EDUCATIONAL AND CORRECTIONAL INSTITUTIONS
DAM WITH ROAD	SCHOOLHOUSE
MINOR DRAINAGE STRUCTURE	OTHER EDUCATIONAL INSTITUTIONS
CITY AND VILLAGE CENTERS	TOWNHALL, GRANGE, OR COMMUNITY HALL
COUNTY SEAT	MUSEUM - GENERAL
OTHER CITIES AND VILLAGES	CORRECTIONAL INSTITUTION
INCORPORATED CITY OR VILLAGE (GENERALIZED)	MISCELLANEOUS
AIRPORTS	TRIANGULATION STATION
AIRFIELD, LIMITED FACILITIES	DOT TO INDICATE LOCATION OF ANY CULTURAL FEATURE SHOWN OUT OF POSITION
LANDING AREA OR STRIP	ALL VACANT CULTURE INDICATED BY OPEN SYMBOL
NAVIGATION	LATITUDE AND LONGITUDE
DOCK, PIER, OR LANDING	
NATURAL FEATURES	
PROMINENT ELEVATION - WITH NAME	

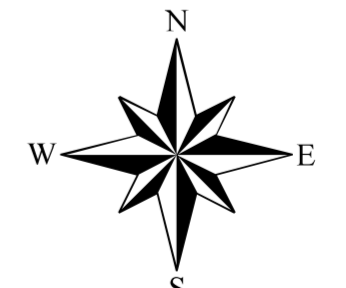

GENERAL HIGHWAY MAP BENSON COUNTY NORTH DAKOTA

PREPARED BY THE
NORTH DAKOTA DEPARTMENT OF TRANSPORTATION
PLANNING AND ASSET MANAGEMENT DIVISION
IN COOPERATION WITH THE
U.S. DEPARTMENT OF TRANSPORTATION
FEDERAL HIGHWAY ADMINISTRATION

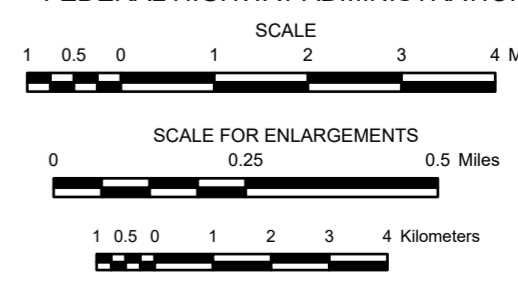

FUNCTIONAL CLASSIFICATION

- PRINCIPAL ARTERIAL
- MINOR ARTERIAL
- MAJOR COLLECTOR
- INDIAN SERVICE ROAD (IS)

REVISION DATE AND CHANGE

01-04-2008 Added 0.4 miles of CMC0359

2022
BASED ON AERIAL PHOTOGRAPHY OF 1957 AERIAL INVENTORY OF 2022
UNIVERSAL TRANSVERSE MERCATOR ZONE 14 NORTH AMERICAN DATUM 83

GENERAL HIGHWAY MAP BENSON COUNTY NORTH DAKOTA 3-1 SHEET 1 OF 2

Notice of Disclaimer
The North Dakota Department of Transportation (NDDOT) makes this map available on an "as is" basis as a public service. Under no circumstances does NDDOT warrant or certify the information to be free of errors or deficiencies of any kind. NDDOT specifically disclaims all warranties, express or implied, including but not limited to the warranties of merchantability and fitness for a particular purpose.