

# 2007 FUNCTIONAL CLASSIFICATION

NAME AND LOCATION OF ORGANIZED CIVIL TOWNSHIPS THOSE UNORGANIZED ARE SO NOTED

T. 144 N. - R. 79 W. WILSON	T. 140 N. - R. 80 W. UNORGANIZED
T. 144 N. - R. 78 W. STEIBER	T. 140 N. - R. 79 W. NAUGHTON
T. 144 N. - R. 77 W. SCHRUNK	T. 140 N. - R. 78 W. FRANCES
T. 144 N. - R. 76 W. FLORENCE LAKE	T. 140 N. - R. 77 W. SIBLEY BUTTE
T. 144 N. - R. 75 W. HAZEL GROVE	T. 140 N. - R. 76 W. CHRISTIANA
T. 143 N. - R. 79 W. GRASS LAKE	T. 140 N. - R. 75 W. CLEAR LAKE
T. 143 N. - R. 78 W. ESTHERVILLE	T. 139 N. - R. 81 W. HAY CREEK
T. 143 N. - R. 77 W. CANFIELD	T. 139 N. - R. 80 W. HAY CREEK
T. 143 N. - R. 76 W. RICHMOND	T. 139 N. - R. 79 W. GIBBS
T. 143 N. - R. 75 W. RICHMOND	T. 139 N. - R. 78 W. MENCKEN
T. 142 N. - R. 81 W. PAINTED WOODS	T. 139 N. - R. 77 W. MCKENZIE
T. 142 N. - R. 80 W. PAINTED WOODS	T. 139 N. - R. 76 W. STERLING
T. 142 N. - R. 79 W. ECKLUND	T. 139 N. - R. 75 W. DRISCOLL
T. 142 N. - R. 78 W. WING	T. 138 N. - R. 80 W. UNORGANIZED
T. 142 N. - R. 77 W. ROCK HILL	T. 138 N. - R. 79 W. APPLE CREEK
T. 142 N. - R. 76 W. WING	T. 138 N. - R. 78 W. BOYD
T. 141 N. - R. 75 W. HARRIETT	T. 138 N. - R. 77 W. LOSAN
T. 141 N. - R. 74 W. GLENVIEW	T. 138 N. - R. 76 W. TAFT
T. 141 N. - R. 73 W. TRYGG	T. 138 N. - R. 75 W. THELMA
T. 141 N. - R. 72 W. CROMWELL	T. 137 N. - R. 80 W. UNORGANIZED
T. 141 N. - R. 71 W. TRYGG	T. 137 N. - R. 79 W. MISSOURI
T. 141 N. - R. 70 W. CROMWELL	T. 137 N. - R. 78 W. TELFER
T. 141 N. - R. 69 W. UNORGANIZED	T. 137 N. - R. 77 W. MORTON
T. 141 N. - R. 68 W. LEIN	T. 137 N. - R. 76 W. LONG LAKE
T. 140 N. - R. 81 W. UNORGANIZED	T. 137 N. - R. 75 W. WILD ROSE

### GENERAL LEGEND

<b>ROADS AND ROADWAY FEATURES</b>	<b>PUBLIC SERVICE FACILITIES</b>
PRIMITIVE ROAD	HIGHWAY GARAGE
UNIMPROVED ROAD	FIRE ENGINE HOUSE
GRADED AND DRAINED ROAD	GARBAGE OR RUBBISH DUMP
GRAVEL GRADED AND DRAINED ROAD	SEWAGE DISPOSAL PLANT
PAVED ROAD	AUTOMOBILE GRAVEYARD
STREETS IN UNINCORPORATED AREAS	WATER SUPPLY STAND PIPE OR TANK
INTERCHANGE	POWER SUBSTATION
INDIAN SERVICE ROAD	BOOSTER STATION
COUNTY MAJOR COLLECTOR	BROADCASTING STATION (RADIO OR TV)
ROUTE NUMBER	COMMUNICATION TOWER
POINTS BETWEEN WHICH DISTANCES ARE MEASURED	MUNICIPAL BUILDING
INTERSTATE NUMBERED HIGHWAY	WEATHER OBSERVATION STATION
U.S. NUMBERED HIGHWAY	
STATE HIGHWAY SYSTEM	<b>CONSERVATION AND RECREATION</b>
	PICNIC GROUND
	PLAYGROUND, BALL FIELD, ETC.
	BATHING BEACH OR SWIMMING POOL
	TOURIST COURT OR MOTEL
	CAMP OR LODGE
	REST AREA
	(PERMANENT SITE WITH BUILDINGS)
	REST AREA
	SMALL PARK (SP-STATE, CP-COUNTY, MP-MUNICIPAL, WP-WAYSIDE PARK)
	GOLF GROUND OR COUNTRY CLUB
	AMUSEMENT PARK OR HALL
	FAIR GROUND, RACE COURSE, SPEEDWAY
	ARCHERY CLUB
	RIFLE CLUB
	RIDING ACADEMY
	MARINA
	ZOO
	<b>FARM UNITS, DWELLINGS, ETC.</b>
	FARM UNIT (FARM UNITS SHOWN IN MUNICIPAL LIMITS INDICATE FARM BUILDINGS FOR FARM USE)
	DWELLING OTHER THAN FARM
	ROWS OR GROUPS OF DWELLINGS CLOSELY SPACED (FIGURE DENOTES NUMBER OF DWELLINGS)
	BARRACKS, OR DORMATORIES FOR STUDENTS, WORKERS, MIGRANTS, ETC.
	SEASONAL OR SUMMER COLONY
	DWELLING
	CHURCH
	CEMETERY
	CHURCH WITH CEMETERY ADJACENT
	TENANT HOUSE
	<b>STRUCTURES</b>
	HIGHWAY BRIDGE, GENERAL
	HIGHWAY GRADE SEPARATION
	DAM WITH ROAD
	MINOR DRAINAGE STRUCTURE
	FORD - ROAD ESTABLISHED
	TRUSS OR GIRDER
	<b>INDUSTRIAL</b>
	STORE OR SMALL BUSINESS
	ESTABLISHMENT
	BUSINESS AND POST OFFICE
	FACTORY OR INDUSTRIAL PLANT
	GROUP OF STORAGE TANKS (OIL OR GAS)
	FILLING STATION
	PUMPING STATION (OIL OR GAS)
	WAREHOUSE - GENERAL
	GRAIN ELEVATOR
	STOCK YARD - LOADING PEN OR CORRAL
	GRAVEL PIT
	GREENHOUSE
	MINE - SHAFT OR DRIFT (ANY KIND)
	NURSERY
	WIND TURBINE
	<b>AIRPORTS</b>
	AIRPORT, COMPLETE FACILITIES
	LANDING AREA OR STRIP
	AIRWAY LIGHT BEACON, GENERAL

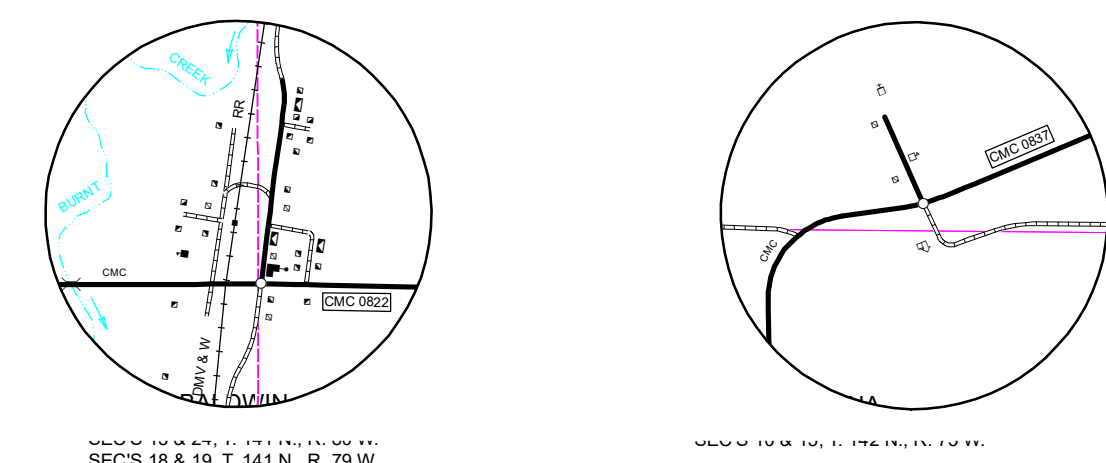
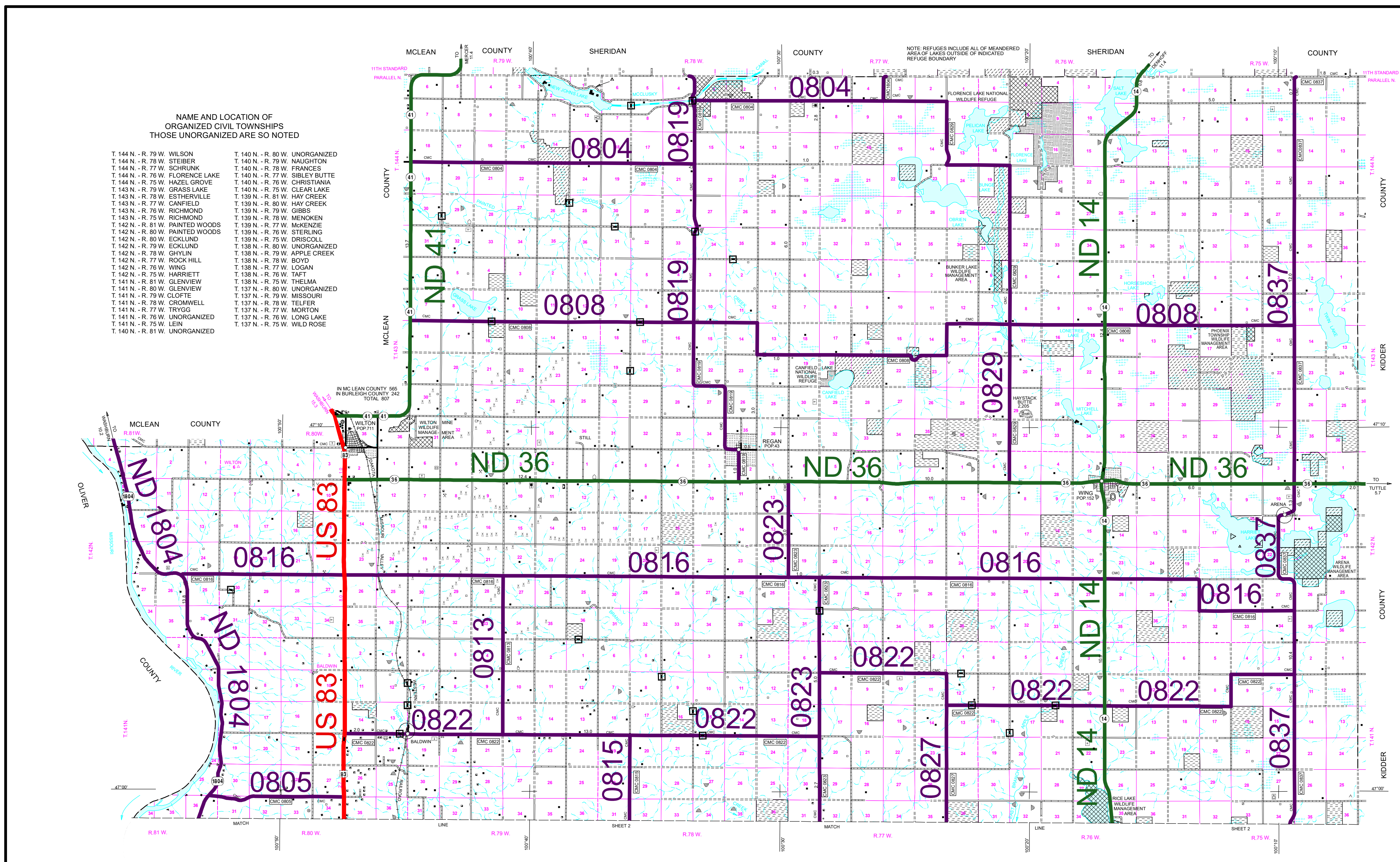

### LEGEND

<span style="color: red;">—</span>	INTERSTATE
<span style="color: orange;">—</span>	PRINCIPAL ARTERIAL
<span style="color: green;">—</span>	MINOR ARTERIAL
<span style="color: purple;">—</span>	MAJOR COLLECTOR

### REVISION DATE AND CHANGE

03-04-2010	Addition of 2 miles to CMC0816
03-04-2010	Removal of 9 miles of CMC0819
03-04-2010	Addition of 7 miles to CMC0822
10-05-2020	Addition of 30 miles to CMC0808
10-05-2020	Addition of 16 miles to CMC0829
10-05-2020	Addition of 16 miles to CMC0816
10-05-2020	Addition of 5 miles to CMC0813
10-05-2020	Addition of 10 miles to CMC0823

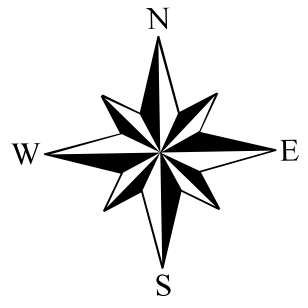
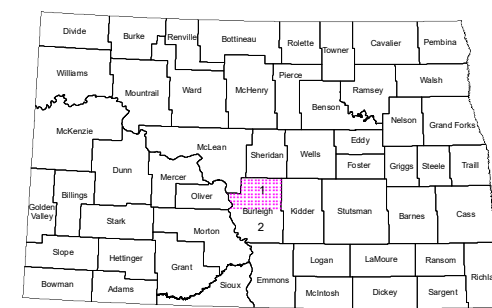

## GENERAL HIGHWAY MAP BURLEIGH COUNTY NORTH DAKOTA

PREPARED BY THE  
NORTH DAKOTA DEPARTMENT OF TRANSPORTATION  
PLANNING / ASSET MANAGEMENT DIVISION

IN COOPERATION WITH THE  
U.S. DEPARTMENT OF TRANSPORTATION  
FEDERAL HIGHWAY ADMINISTRATION

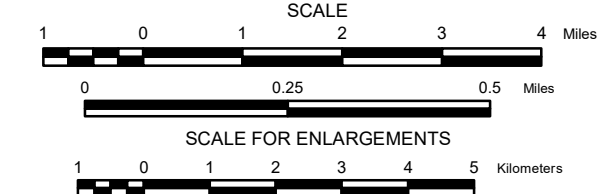

2013

BASED ON AERIAL PHOTOGRAPHY OF 1957  
GROUND INVENTORY OF 2013  
AERIAL INVENTORY OF 2013

UNIVERSAL TRANSVERSE MERCATOR ZONE 14  
NORTH-AMERICAN DATUM 83

**Notice of Disclaimer**  
The North Dakota Department of Transportation (NDDOT) makes this map available on an "as is" basis as a public service. Under no circumstances does NDDOT warrant or certify the information to be free of errors or deficiencies of any kind. NDDOT specifically disclaims all warranties, express or implied, including but not limited to the warranties of merchantability and fitness for a particular purpose.

COPIES OF THIS MAP ARE AVAILABLE FOR PUBLIC USE AT A NOMINAL COST FROM:  
MAP SALES, N.D. DEPT. OF TRANSPORTATION, 608 E. BLVD. AVE., BISMARCK, N.D. 58505-0700