

2007 FUNCTIONAL CLASSIFICATION

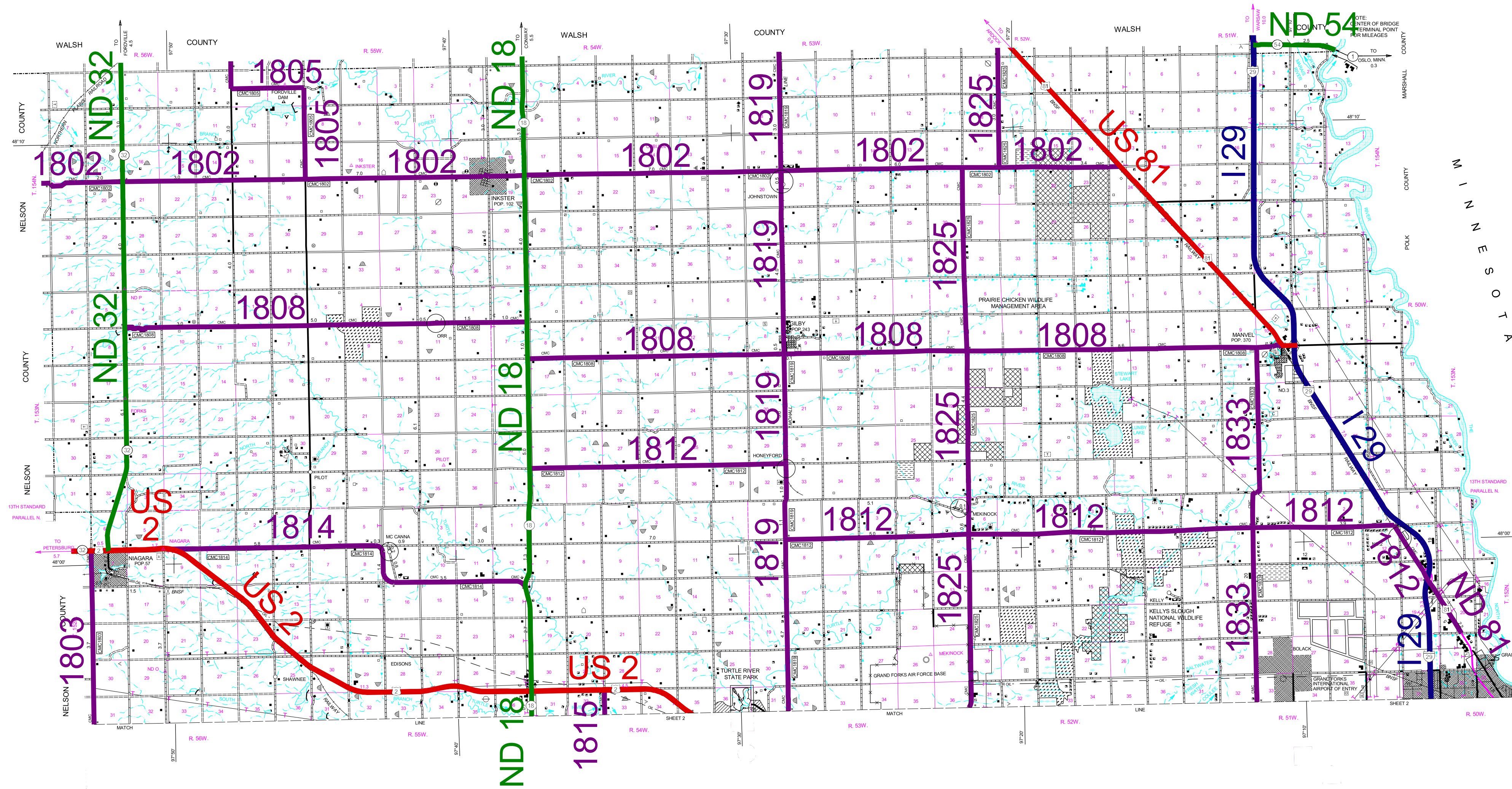

GENERAL LEGEND

ROADS AND ROADWAY FEATURES	STRUCTURES	FARM UNITS, DWELLINGS, ETC.
PRIMITIVE ROAD	HIGHWAY BRIDGE, GENERAL	FARM UNIT (FARM UNITS SHOWN IN MUNICIPAL LIMITS INDICATE FARM BUILDINGS FOR FARM USE)
UNIMPROVED ROAD	HIGHWAY GRADE SEPARATION	DAM WITH ROAD
GRADED AND DRAINED ROAD	FORD - ROAD ESTABLISHED	DWELLING OTHER THAN FARM
PAVED ROAD	LEVEE OR DIKE	ROWS OR GROUPS OF DWELLINGS
4 LANE UNDIVIDED HIGHWAY		CLOSELY SPACED (FIGURE DENOTES NUMBER OF DWELLINGS)
DIVIDED HIGHWAY		SEASONAL OR SUMMER COLONY DWELLING
HIGHWAY WITH FULL CONTROL OF ACCESS		SEASONAL DWELLINGS CLOSELY SPACED
STREETS IN UNINCORPORATED TOWNS		HOTEL OR INN
CLOVER LEAF OR INTERCHANGE		CEMETERY
COUNTY MAJOR COLLECTOR ROUTE NUMBER		CHURCH WITH CEMETERY ADJACENT
POINTS BETWEEN WHICH DISTANCES ARE MEASURED		TOLL HOUSE, STATE PORT OF ENTRY, OR WEIGHT STATION
INTERSTATE NUMBERED HIGHWAY		TENANT HOUSE
U.S. NUMBERED HIGHWAY		BARRACKS, OR DORMITORIES FOR STUDENTS, WORKERS, MIGRANTS, ETC.
STATE HIGHWAY SYSTEM		PUBLIC SERVICE FACILITIES
AIRPORTS		MONUMENT - SMALL, HISTORIC SITE
AIRPORT, COMPLETE FACILITIES		WILDLIFE MANAGEMENT AREA
LANDING AREA OR STRIP		WATERFOWL PRODUCTION AREA
MILITARY FIELD (SOME FACILITIES AVAILABLE)		STATE PARKS
AIRPORT, GENERAL		STATE SCHOOL LAND
RAILROADS		INDUSTRIAL
RAILROAD (ANY NUMBER OF TRACKS USED BY A SINGLE OPERATING CO.)		STORE OR SMALL BUSINESS ESTABLISHMENT
RAILROAD STATION		FACTORY OR INDUSTRIAL PLANT
DRAINAGE		GROUP OF STORAGE TANKS (OIL OR GAS)
INTERMITTENT STREAM (NARROW)		GAUGING OR PUMPING STATION
NARROW STREAM		WAREHOUSE - GENERAL
WIDE STREAM		GRAIN ELEVATOR
WIDE STREAM WITH DAM		GRAVEL PIT
LAKE, RESERVOIR, OR POND WITH DAM		OIL OR GAS WELL
LAKE, RESERVOIR, OR POND		GREENHOUSE
MARSH OR SWAMP LAND		NURSERY
DRAINAGE DITCH		CONSERVATION AND RECREATION
IRRIGATION DITCH		PICNIC GROUND
NAVIGATION		PLAYGROUND, BALL FIELD, ETC.
DOCK, PIER, OR LANDING		BATHING BEACH OR SWIMMING POOL
		CAMP SITE, NO PERMANENCE (TENTS OR TRAILER PARKING)
		TOURIST COURT, OR MOTEL
		REST AREA
		SMALL PARK (SP-STATE, CP-COUNTY, MP-MUNICIPAL, WP-WAYSIDE PARK)
		GOLF GROUND OR COUNTRY CLUB
		AMUSEMENT PARK OR HALL
		FAIR GROUND, RACE COURSE, SPEEDWAY
		RIDING ACADEMY
		DRIVE-IN THEATER
		MUNICIPAL BUILDING
		INCORPORATED CITY OR VILLAGE (GENERALIZED)
		NURSERY
		EDUCATIONAL AND CORRECTIONAL INSTITUTIONS
		SCHOOLHOUSE
		TOWNHALL, GRANGE, OR COMMUNITY HALL
		MISCELLANEOUS
		ARMORY
		TRIANGULATION STATION
		FORT, ARMY CAMP, BARRACKS, OR OTHER MILITARY POST
		DOT TO INDICATE LOCATION OF ANY CULTURAL FEATURE SHOWN OUT OF POSITION
		ALL VACANT CULTURE INDICATED BY OPEN SYMBOL
		LATITUDE AND LONGITUDE

COUNTY MAJOR COLLECTORS END AT URBAN AREA SEE CITY MAP FOR URBAN FUNCTIONAL CLASSIFICATION

LEGEND

	INTERSTATE
	PRINCIPAL ARTERIALS
	MINOR ARTERIALS
	MAJOR COLLECTORS

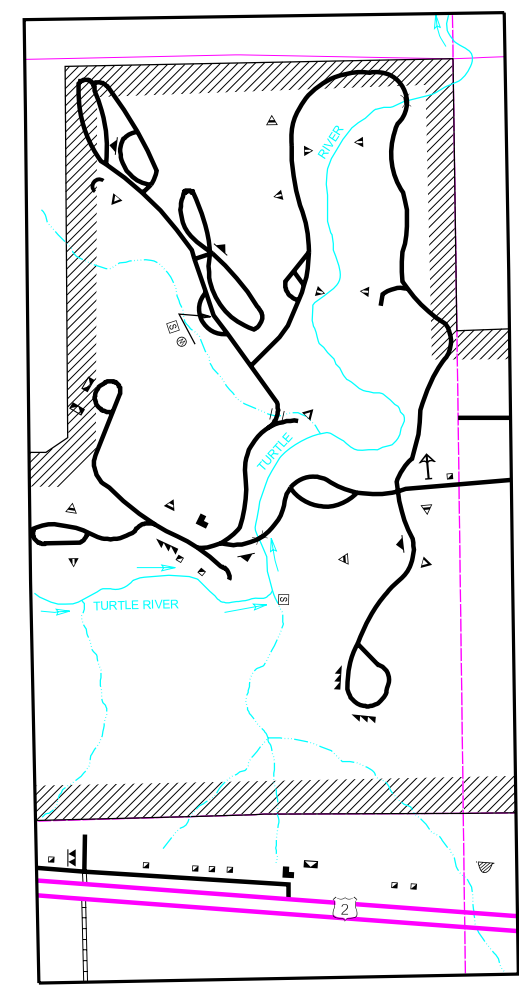

TURTLE RIVER STATE PARK
 SEC'S 30 & 31 T. 152 N., R. 53 W.
 SEC'S 25 & 26 T. 152 N., R. 54 W.
 SEC. 6, T. 151 N., R. 53 W.
 SEC. 1, T. 151 N., R. 54 W.

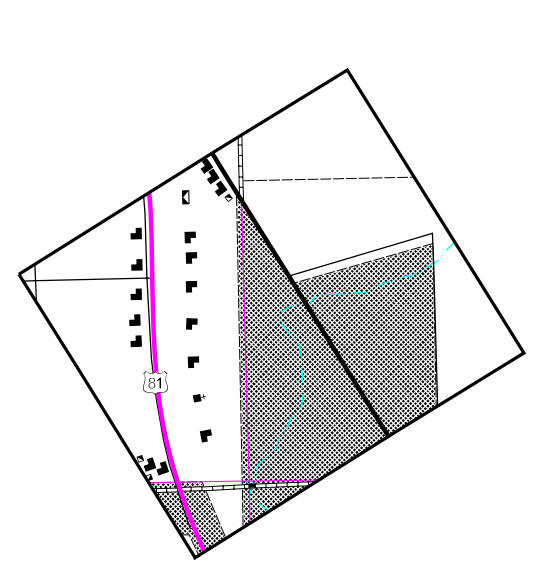

GRAND FORKS NO. 1
 SEC'S 28, 29, 32, & 33, T. 152 N., R. 50 W.

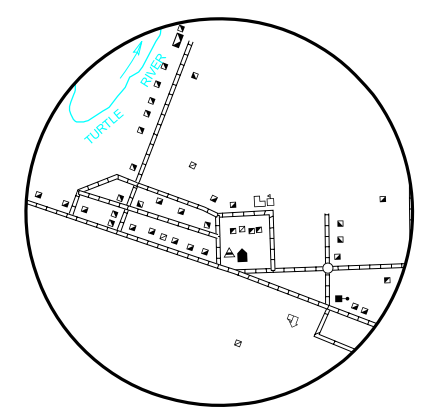

MEKINOCK
 SEC. 1, T. 152 N., R. 53 W.

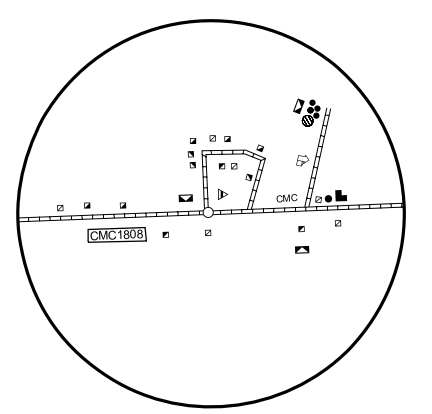

ORR
 SEC'S 2 & 11, T. 153 N., R. 55 W.

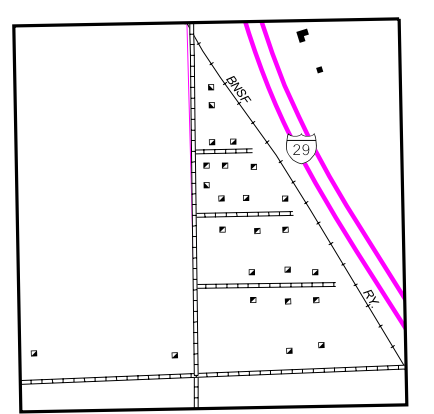

INSET NO. 3
 SEC'S 14, 15, 22, & 23, T. 153 N., R. 51 W.

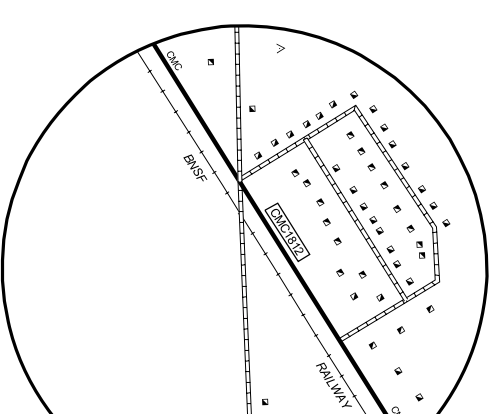

INSET NO. 2
 SEC. 12, T. 152 N., R. 51 W.
 SEC. 7, T. 152 N., R. 50 W.

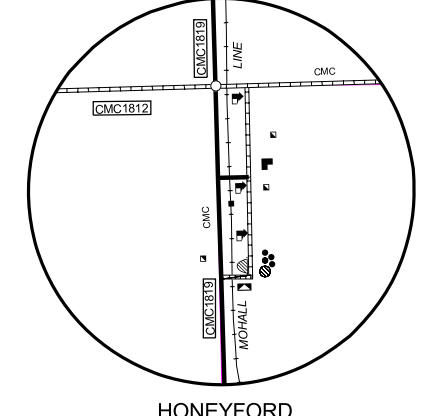

HONEYFORD
 SEC'S 28, 29, 32, & 33, T. 153 N., R. 53 W.

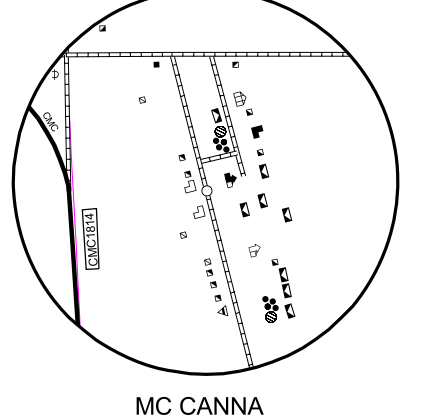

MC CANNA
 SEC'S 4, 5, 8, & 9 T. 152 N., R. 55 W.

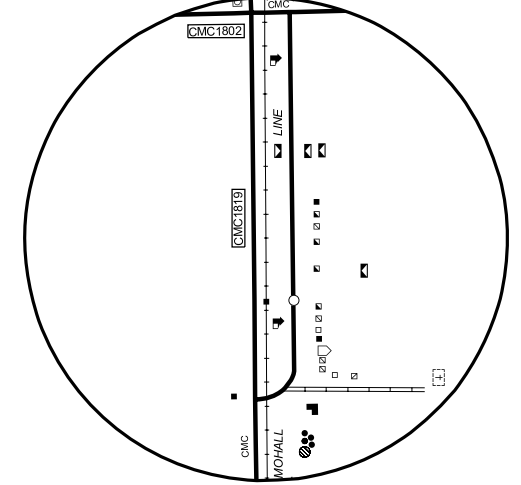

JOHNSTOWN
 SEC'S 16, 17, 20, & 21 T. 154 N., R. 53 W.

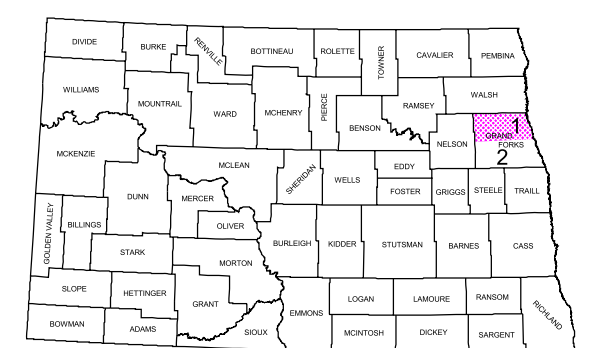

STATE OF NORTH DAKOTA
 DIAGRAM OF COUNTIES

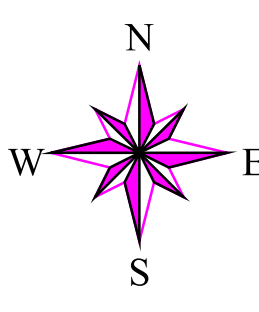

GENERAL HIGHWAY MAP GRAND FORKS COUNTY NORTH DAKOTA

PREPARED BY THE
 NORTH DAKOTA DEPARTMENT OF TRANSPORTATION
 PLANNING AND PROGRAMMING DIVISION

IN COOPERATION WITH THE
 U.S. DEPARTMENT OF TRANSPORTATION
 FEDERAL HIGHWAY ADMINISTRATION

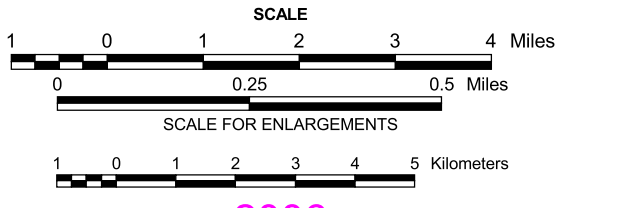

2006

COPIES OF THIS MAP ARE AVAILABLE FOR PUBLIC USE AT A NOMINAL COST FROM:
 MAP SALES, N.D. DEPARTMENT OF TRANSPORTATION, 608 E. BLVD., AVE., BISMARCK, N.D. 58505-0700

BASED ON AERIAL PHOTOGRAPHY OF 1954
 GROUND INVENTORY OF 2006
 AERIAL INVENTORY OF 2006
 UNIVERSAL TRANSVERSE MERCATOR ZONE 14
 NORTH AMERICAN DATUM 83