

# 2007 FUNCTIONAL CLASSIFICATION

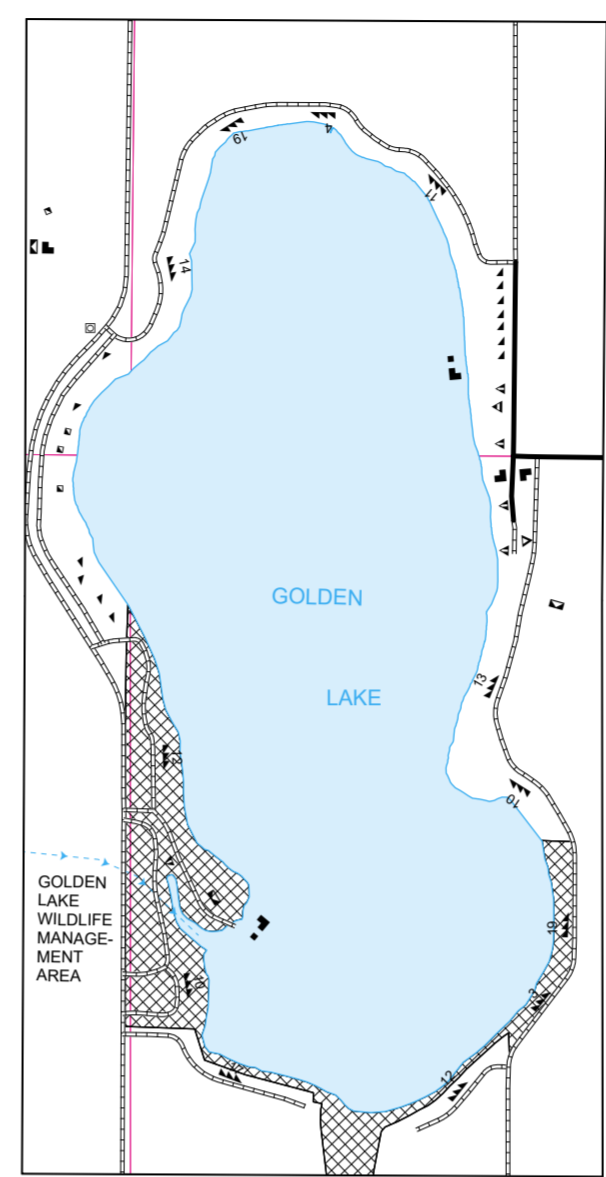

GOLDEN LAKE NO. 1  
SEC'S. 2, 3, 10, & 11, T. 147 N., R. 55 W.

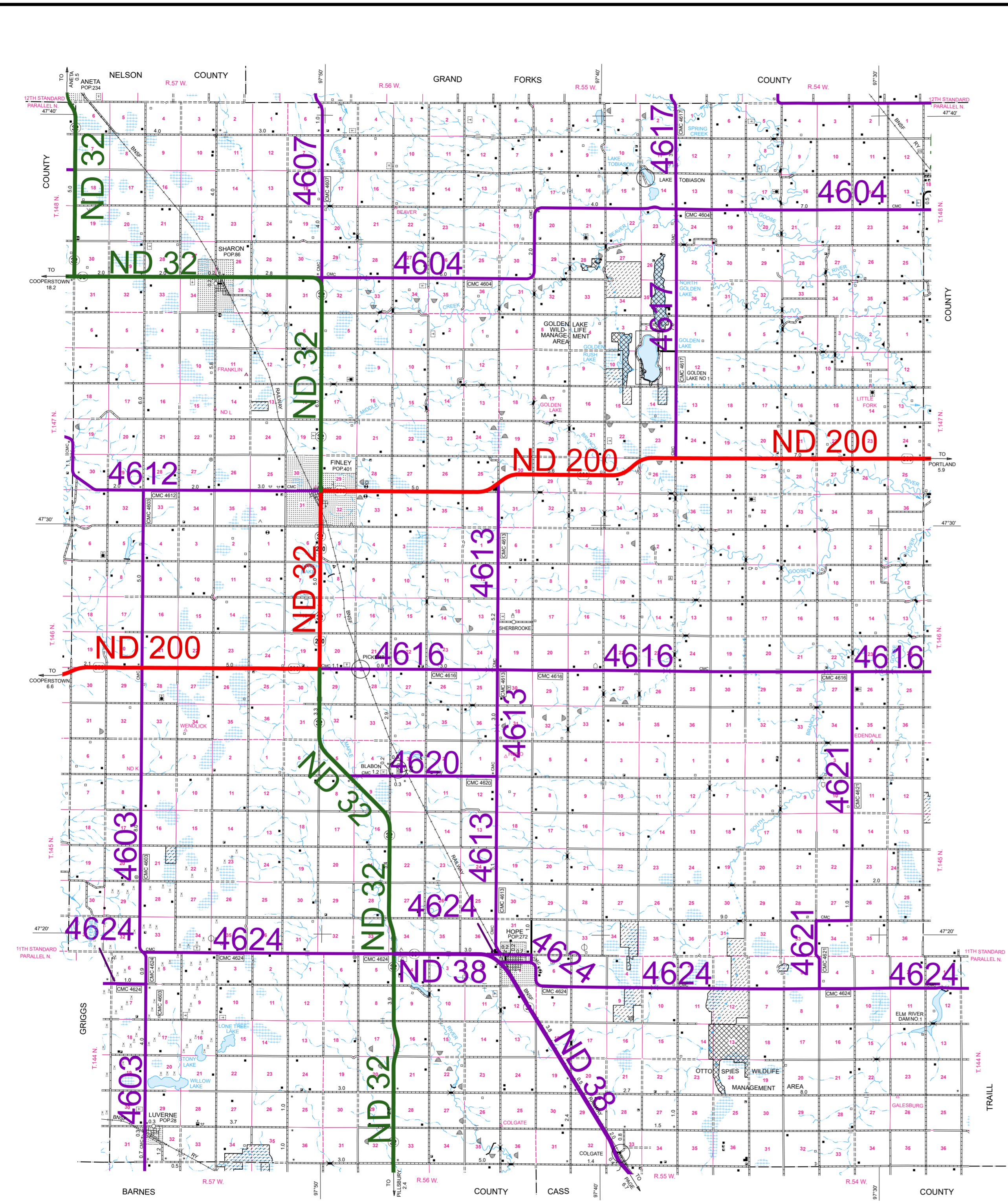
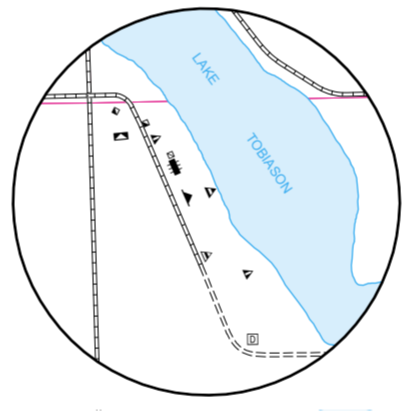

LAKE TOBIASON  
SEC'S. 10, 11, 14, & 15, T. 148 N., R. 55 W.

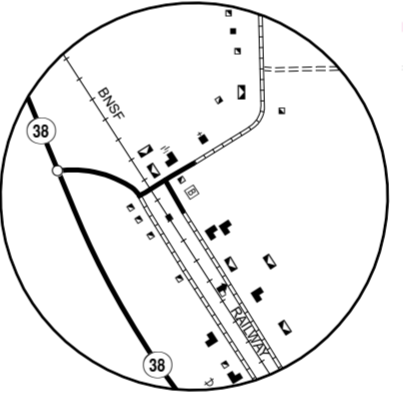

COLGATE  
SEC. 33, T. 144 N., R. 55 W.

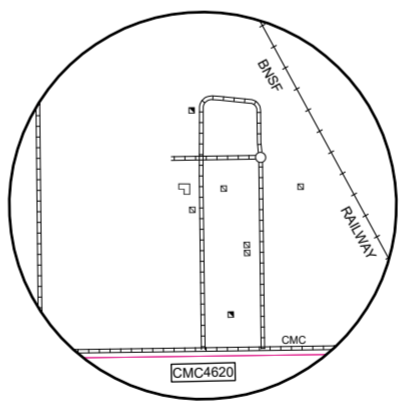

BLABON  
SEC'S. 3, 4, & 10, T. 145 N., R. 56 W.

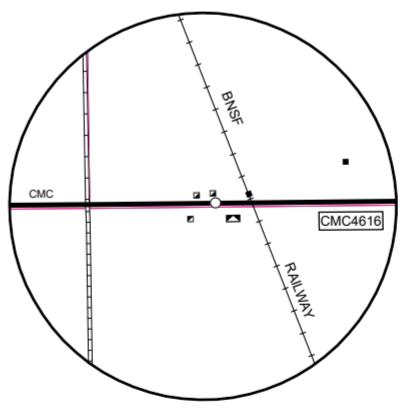

PICKERT  
SEC'S. 20, 21, 28, & 29, T. 146 N., R. 56 W.

- ROADS AND ROADWAY FEATURES**
- PRIMITIVE ROAD
  - UNIMPROVED ROAD
  - GRAVEL GRADED AND DRAINED ROAD
  - PAVED ROAD
  - STREETS IN UNINCORPORATED AREAS
  - COUNTY MAJOR COLLECTOR
  - ROUTE NUMBER
  - POINTS BETWEEN WHICH DISTANCES ARE MEASURED
  - U.S. NUMBERED HIGHWAY
  - STATE HIGHWAY SYSTEM
- BOUNDARIES**
- COUNTY LINE
  - TOWNSHIP LINE
  - CORPORATE LINE
  - SECTION LINE
  - BOUNDARY TO MARK ENLARGEMENT INSET
  - NATIONAL REFUGES
  - WILDLIFE MANAGEMENT AREA
  - WATERFOWL PRODUCTION AREA
  - STATE SCHOOL LAND
  - RESERVOIR BOUNDARY (TAKING LINE)
- DRAINAGE**
- INTERMITTENT STREAM (NARROW)
  - NARROW STREAM
  - WIDE STREAM
  - WIDE STREAM WITH DAM
  - LAKE, RESERVOIR, OR POND
  - LAKE, RESERVOIR, OR POND WITH DAM
  - MARSH OR SWAMP LAND
  - DRAINAGE DITCH
  - IRRIGATION DITCH
- NAVIGATION**
- DOCK, PIER, OR LANDING
- STRUCTURES**
- HIGHWAY BRIDGE, GENERAL
  - HIGHWAY GRADE SEPARATION
  - DAM WITH ROAD
  - MINOR DRAINAGE STRUCTURE
  - FORD - ROAD ESTABLISHED

- GENERAL LEGEND**
- RAILROADS**
- RAILROAD (ANY NUMBER OF TRACKS USED BY A SINGLE OPERATING CO.)
  - RAILROAD STATION
  - RAILROAD GRADE CROSSING
  - RAILROAD ABOVE
  - RAILROAD BELOW
  - SEASONAL DWELLINGS CLOSELY SPACED
  - RAILROAD BRIDGE
- AIRPORTS**
- AIRFIELD, LIMITED FACILITIES
  - LANDING AREA OR STRIP
- CONSERVATION AND RECREATION**
- PICNIC GROUND
  - PLAYGROUND, BALL FIELD, ETC.
  - BATHING BEACH OR SWIMMING POOL
  - CAMP SITE, NO PERMANENCE (TENTS OR TRAILER PARKING)
  - CAMP OR LODGE (PERMANENT SITE WITH BUILDINGS)
  - GOLF GROUND OR COUNTRY CLUB
- PUBLIC SERVICE FACILITIES**
- GARAGE OR RUBBISH DUMP
  - SEWAGE DISPOSAL PLANT
  - POWER SUBSTATION
  - WATER SUPPLY STAND PIPE OR TANK
  - COMMUNICATION TOWER
  - SCRAP METAL
- CITY AND VILLAGE CENTERS**
- COUNTY SEAT
  - OTHER CITIES AND VILLAGES
  - INCORPORATED CITY OR VILLAGE (GENERALIZED)
- EDUCATIONAL AND CORRECTIONAL INSTITUTIONS**
- SCHOOLHOUSE
  - TOWNHALL, GRANGE, OR COMMUNITY HALL
- FARM UNITS, DWELLINGS, ETC.**
- FARM UNIT (FARM UNITS SHOWN IN MUNICIPAL LIMITS INDICATE FARM BUILDINGS FOR FARM USE)
  - DWELLING OTHER THAN FARM BARRACKS, OR DORMATORIES FOR STUDENTS, WORKERS, MIGRANTS, ETC.
  - SEASONAL OR SUMMER COLONY
  - DWELLING
  - SEASONAL DWELLINGS CLOSELY SPACED
  - CHURCH
  - CEMETERY
  - CHURCH WITH CEMETERY ADJACENT
  - WELL
- INDUSTRIAL ESTABLISHMENT**
- STORE OR SMALL BUSINESS
  - FACTORY OR INDUSTRIAL PLANT
  - GAUGING OR PUMPING STATION
  - PUMPING STATION (OIL OR GAS)
  - WAREHOUSE - GENERAL
  - GRAIN ELEVATOR
  - GRAVEL PIT
  - WIND TURBINE
- MISCELLANEOUS**
- TRIANGULATION STATION
  - DOT TO INDICATE LOCATION OF ANY CULTURAL FEATURE SHOWN OUT OF POSITION
  - ALL VACANT CULTURE INDICATED BY OPEN SYMBOL
  - LATITUDE AND LONGITUDE

**FUNCTIONAL CLASSIFICATION**

- INTERSTATE
- PRINCIPAL ARTERIAL
- MINOR ARTERIAL
- MAJOR COLLECTOR

**REVISION DATE AND CHANGE**

- 05-26-2015 Removed 0.2 miles of CMC4613
- 05-26-2015 Removed 0.9 miles of CMC4624
- 05-26-2015 Extension of 1.4 miles to CMC4624

- NAME AND LOCATION OF ORGANIZED CIVIL TOWNSHIPS THOSE UNORGANIZED ARE SO NOTED**
- T. 148 N.-R. 57 W. SHARON
  - T. 148 N.-R. 56 W. WESTFIELD
  - T. 148 N.-R. 55 W. BEAVER CREEK
  - T. 148 N.-R. 54 W. NEWBURGH
  - T. 147 N.-R. 57 W. FRANKLIN
  - T. 147 N.-R. 56 W. FINLEY
  - T. 147 N.-R. 55 W. GOLDEN LAKE
  - T. 147 N.-R. 54 W. ENGER
  - T. 146 N.-R. 57 W. GREENVIEW
  - T. 146 N.-R. 56 W. EASTON
  - T. 146 N.-R. 55 W. SHERBROOKE
  - T. 146 N.-R. 54 W. PRIMROSE
  - T. 145 N.-R. 57 W. RIVERSIDE
  - T. 145 N.-R. 56 W. MELROSE
  - T. 145 N.-R. 55 W. HUGO
  - T. 145 N.-R. 54 W. EDENDALE
  - T. 144 N.-R. 57 W. WILLOW LAKE
  - T. 144 N.-R. 56 W. CARPENTER
  - T. 144 N.-R. 55 W. COLGATE
  - T. 144 N.-R. 54 W. BROADLAWN

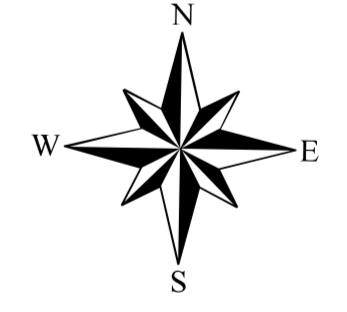

## GENERAL HIGHWAY MAP STEELE COUNTY NORTH DAKOTA

PREPARED BY THE  
NORTH DAKOTA DEPARTMENT OF TRANSPORTATION  
PLANNING AND ASSET MANAGEMENT DIVISION

IN COOPERATION WITH THE  
U.S. DEPARTMENT OF TRANSPORTATION  
FEDERAL HIGHWAY ADMINISTRATION

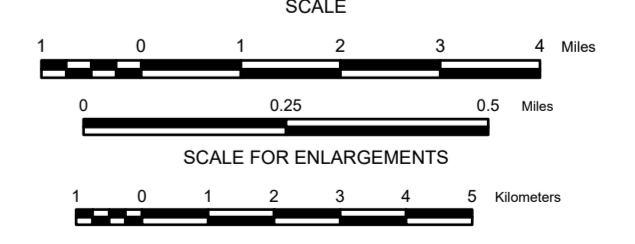

2020

BASED ON AERIAL PHOTOGRAPHY OF 1954  
UNIVERSAL TRANSVERSE MERCATOR ZONE 14  
AERIAL INVENTORY OF 2020 NORTH AMERICAN DATUM 83

SHEET 1 OF 1

**Notice of Disclaimer**  
The North Dakota Department of Transportation (NDOT) makes this map available on an "as is" basis as a public service. Under no circumstances does NDOT warrant or certify the information to be free of errors or deficiencies of any kind. NDOT specifically disclaims all warranties, express or implied, including but not limited to the warranties of merchantability and fitness for a particular purpose.

